

# CORNER RECORD

Documented Number 011-102-17

City of San Rafael County of Marin, California

Brief Legal Description Lands of Franchetti (now Downs) as shown on 1988 Maps 75

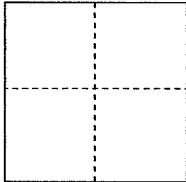

### CORNER TYPE

Government Corner  Control   
Meander  Property   
Rancho  Other

### COORDINATES(Optional)

N. \_\_\_\_\_  
E. \_\_\_\_\_  
Zone \_\_\_\_\_ NAD27  NAD83   
NAD83 Epoch \_\_\_\_\_  
Elevation \_\_\_\_\_  
Vert. Datum: NGVD 29  NADV88   
Meas. Units: Metric  Imperial

Date of Survey 09/24/2013

Corner- Left as found  Found and tagged  Established  Reestablished  Rebuilt

Identification and type of corner found: Evidence used to identify or procedure used to establish or reestablish the corner:  
**Reestablish the Easterly line of the Lands of Franchetti (now Downs) as shown upon 1998 Maps 75 from existing found markers of said map and from points shown upon the Corner Record done by this office for the Westerly and Southerly lines of this same parcel of land that was filed 12/17/2008 in the Department of Public Works. See sketch on reverse side for details.**

A description of the physical condition of the monument as found and as set or reset: **Set the Northeast and Southeast lot corner and randomly set points on said Easterly line. Set either a one half inch rebar with PLS cap stamped "Scranton, PLS 5379" with cap set flush to surrounding grade or set brass nail with brass tag stamped "LS 5379". See sketch for locations of points set.**

### SURVEYOR'S STATEMENT

This Corner Record was prepared by me or under my direction in conformance with

the Land Surveyor's Act on October 3, 2013

Signed *Douglas J. Scranton* P.L.S. or R.C.E. No.: PLS 5379

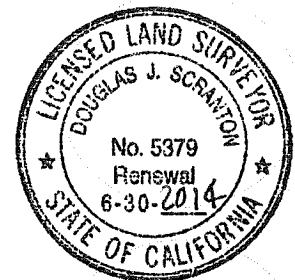

### COUNTY SURVEYOR'S STATEMENT

This Corner Record was received OCTOBER 15, 2013 and examined

and filed DECEMBER 12, 2013

Signed *Richard G. Simonitch* P.L.S. or R.C.E. No.: 7821



Title DEPUTY CO. SURVEYOR

County Surveyor's Comment \_\_\_\_\_  
\_\_\_\_\_  
\_\_\_\_\_

SCALE: 1" = 20'

SET BRASS TAG LS 5379 WITH BRASS NAIL ON TOP OF 4x4 FENCE POST

FOUND LS 3775 PLUG AND TAG ON TOP OF STONE PILLAR PER R1

NOTE: DISTANCE SHOWN IS FROM CORNER POINT TO TAG. SEE ALSO DETAIL ONE FOR ADDITIONAL POINT SET ON THE REAR LOT LINE 0.51' FROM THE REAR LOT CORNER.

SET BRASS TAG LS 5379 WITH BRASS NAIL ON TOP OF 4x4 FENCE POST

DETAIL 1  
N.T.S.

SEE DETAIL 1

SEE R1

**BASIS OF BEARINGS**

TAKEN AS SOUTH 88°49'25" EAST BETWEEN MONUMENTS AS SHOWN AND AS SAID MONUMENTS ARE DEPICTED UPON R1

**REFERENCES**

R1 MARIN COUNTY CORNER RECORD FOR APN 011-102-17 FILED DECEMBER 17, 2008 BY THIS OFFICE

**LEGEND**

- SET 1/2" REBAR/PLS 5379
- FOUND MONUMENT AS NOTED
- ⊗ SET BRASS NAIL WITH BRASS TAG LS 5379 IN CONCRETE UNLESS NOTED OTHERWISE

N.T.S. NOT TO SCALE

ALL DISTANCES GIVEN IN FEET AND DECIMALS THEREOF  
NO EASEMENTS ARE DEPICTED

BASIS OF BEARINGS  
R1 MAP CALC.  
CALC AND MEAS.

PROSPECT DRIVE (30')

S63°29'31"W 134.09'

86.80'

0.50' (N.T.S.)

47.29'

FOUND NAIL WITH LS TAG 3887 PER R1

S53°00'00"E 23.85'

FOUND BRASS TAG LS 5379 WITH BRASS NAIL PER R1

S64°25'00"E 49.65'

FOUND BRASS TAG LS 5379 WITH BRASS NAIL PER R1

N69°00'00"E 110.07'

S88°49'25"E 306.05'

N39°40'00"W 73.00'

21.10'

16.00'

25.00'

N39°40'00"W

10.39'

21.10'

S63°29'31"W

0.51'