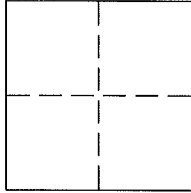

CORNER RECORD

Agency Index

AP: 010-311-10

Document Number

City of SAN RAFAEL County of MARIN, CaliforniaBrief Legal Description: LOT 49 OF MAP ENTITLED "MAP OF WHITE OAKS UNIT TWO", FILED 11/24/1961 IN BOOK 11 OF MAPS AT PAGE 3, MARIN COUNTY OFFICIAL RECORDS.**CORNER TYPE****COORDINATES (Optional)**Government Corner ☐ Control ☐
Meander ☐ Property ☒
Rancho ☐ Other ☐Date of Survey 3/22/2017

N: _____ E: _____

Elevation: _____

Units: Metric ☐ US Survey Foot ☐

Horizontal Datum _____

Zone: _____ Epoch Date _____

Vertical Datum: _____

☐ Complies with Public Resources Code §§8801-8819☐ Complies with Public Resources Code §§8890-8902PLS Act Ref.: ☒ 8765(d) ☒ 8771 ☒ 8773 ☐ Other:Corner/
Monument: ☒ Left as found ☒ Established ☐ Rebuilt ☐ Pre-Construction
☐ Found and tagged ☐ Reestablished ☐ Referenced ☐ Post-Construction

Narrative of corner identified and monument as found, set, reset, replaced, or removed:

☒ See sheet #2 for description(s):

FOUND ORIGINAL CENTERLINE MONUMENTS PER "MAP OF WHITE OAKS UNIT TWO", FILED 11/24/1961 IN BOOK 11 OF MAPS, AT PAGE 3 AND SET MARKERS AS DESCRIBED AND SHOWN ON PAGE 2.

SURVEYOR'S STATEMENT

This Corner Record was prepared by me or under my direction in conformance with

the Professional Land Surveyors' Act on APRIL 11, 2017Signed: John Elmer P.L.S.No. 9361**COUNTY SURVEYOR'S STATEMENT**The Corner Record was received April 12, 2017and examined and filed MAY 24, 2017Signed: John R. Semerad P.L.S. or R.C.E.No. 9292Title: DEPUTY C.S.

County Surveyor's Comment

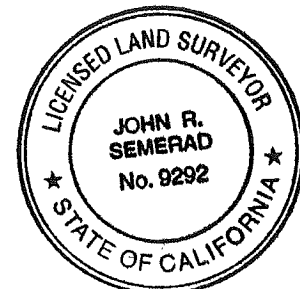

LEGEND

- SUBJECT BOUNDARY LINES PER R1
- OTHER BOUNDARY LINES PER R1
- MONUMENT LINE PER R1
- TIE LINE
- ⊙ FOUND 1/8" PIN IN 5" DIA. CONC. CYLINDER IN HANDHOLE PER R1
- FOUND 3/4" IRON PIPE & BRASS TAG RCE 5948 PER R2
- SET #5 REBAR & PLASTIC CAP LS 9361
- R1 RECORD MAP: BOOK 11, PAGE 3
- R2 PARCEL MAP: BOOK 11, PAGE 96
- DIA. DIAMETER
- CONC. CONCRETE

AMERICAN LAND SURVEYING, INC.

316 Tennessee Avenue, Mill Valley, Ca 94941

P:(415) 888-8580 ALS17011 E:office@alspls.com

CORNER RECORD

