

# CORNER RECORD

Agency Index

DPW# 18-046

Document Number

APN 006-052-23-ADJ

City of SAN ANSELMOCounty of MARIN

, California

Brief Legal Description MONUMENT ON MADRONE AVENUE.

## CORNER TYPE

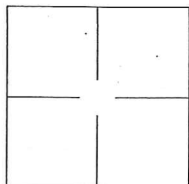

Government Corner

☐

Control

☐

Meander

☐

Property

☐

Rancho

☐

Other

☒Date of Survey 2018-06-18

## COORDINATES (Optional)

N. \_\_\_\_\_

E. \_\_\_\_\_

Elevation \_\_\_\_\_

Units

Metric ☐U.S. Survey Foot ☐

Horizontal Datum \_\_\_\_\_

Zone \_\_\_\_\_

Epoch Date \_\_\_\_\_

Vertical Datum: \_\_\_\_\_

☐ Complies with Public Resources Code §§8801-8819☐ Complies with Public Resources Code §§8890-8902

PLS Act Ref.:

☐

8765(d)

☒

8771

☐

8773

Other: \_\_\_\_\_

Corner/  
Monument:☒

Left as found

☐

Established

☐

Rebuilt

☒

Pre-Construction

☐

Found and tagged

☐

Reestablished

☐

Referenced

☐

Post-Construction

Narrative of corner identified and monument as found and set or reset:

☒ See sheet #2 for description(s):

FOUND MONUMENT IN MADRONE AVENUE. NO REFERENCE.

## SURVEYOR'S STATEMENT

This Corner Record was prepared by me or under my direction in conformance with

the Land Surveyor's Act on

18 OCT2018

Signed

P.L.S. or R.C.E. No.:

8040

## COUNTY SURVEYOR'S STATEMENT

This Corner Record was received

JUNE 29, 2018

and examined

and filed

NOV. 15.2018

Signed

  
DEPUTY C.S.

P.L.S. or R.C.E. No.:

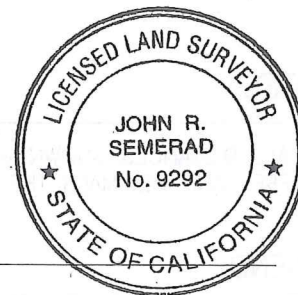
9292

County Surveyor's Comment \_\_\_\_\_

APN: 006-052-18

68 MADRONE AVE.

APN: 006-052-23

74 MADRONE AVE.

MADRONE AVENUE

APN: 006-083-27

SET MAG NAIL IN  
TOP OF CURB  
TAGGED LS 8040

SET MAG NAIL IN  
TOP OF CURB  
TAGGED LS 8040

FOUND 2" BRASS DISK  
WITH PUNCH MARK,  
NO STAMP, IN  
MONUMENT WELL

SET 3/4" IRON  
PIPE W/TACK  
TAGGED LS 8040

CUT X ON TOP  
OF CURB TAGGED  
LS 8040

SCALE

1" = 10'

## NOTES

1. ALL DISTANCES SHOWN HEREON ARE IN U.S. SURVEY FEET AND DECIMALS THEREOF.

## LEGEND:

- FOUND MONUMENT AS NOTED
- SET REFERENCE POINT AS NOTED