

AP # 5-205-06

CORNER RECORD

Document Number 04-58796

City of San Anselmo

County of Marin, California

Brief Legal Description Lot 312 (4 RM 22)

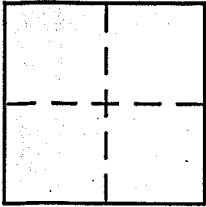

CORNER TYPE

Government Corner Control
 Meander Property
 Rancho Other
 Date of Survey _____

COORDINATES (Optional)

N. _____
 E. _____
 Zone _____ NAD27 NAD83
 NAD83 Epoch _____
 Elev. _____
 Vert. Datum: NGVD29 NAVD88
 Meas. Units: Metric Imperial

Corner - Left as found Found and tagged Established Reestablished Rebuilt

Identification and type of corner found: Evidence used to identify or procedure used to establish or reestablish the corner:

Found monuments per Record of Survey (2005-Maps-279), see page 2.

A description of the physical condition of the monument as found and as set or reset: Set monuments as shown on reverse, see page 2.

SURVEYOR'S STATEMENT

This Corner Record was prepared by me or under my direction in conformance with

the Land Surveyor's Act on November 5, 2005

Signed [Signature] P.L.S. or R.C.E. No. 5814

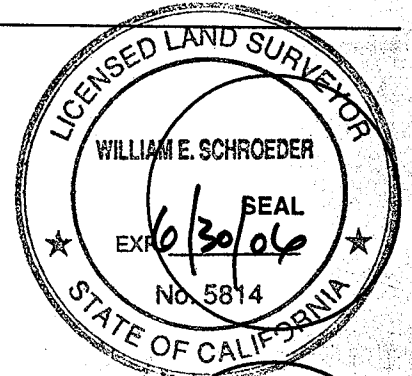

COUNTY SURVEYOR'S STATEMENT

This Corner Record was received NOVEMBER 8, 2005

and examined and filed DECEMBER 8, 2005

Signed [Signature] P.L.S. or R.C.E. No. 7128

Title COUNTY SURVEYOR

County Surveyor's Comment _____

