

CORNER RECORD

Assessor's Parcel No. 005-171-05

San Anselmo County of Marin California

Brief Legal Description: Lot 47, 5 RM 35, Marin County Records

CORNER TYPE

**COORDINATES
(Optional)**

Lot shown on a Subdivision Map

None

Corners - None found. Calculated property boundary based on the Subdivision Map filed in 5 RM 35, Marin County Records.

Set, two property corner monuments as shown on this Corner Record.

Description of Monuments reset: See page 2.

SURVEYOR'S STATEMENT

This Corner Record was prepared by me or under my direction in conformance with the Land Surveyor's Act on July 22, 2014.



Signed Dale White LS 4397

COUNTY SURVEYOR'S STATEMENT

This Corner Record was received 08/27, 20 14, and examined and filed OCTOBER 15, 20 14.

Signed Richard G. Simonitch Title DEPUTY

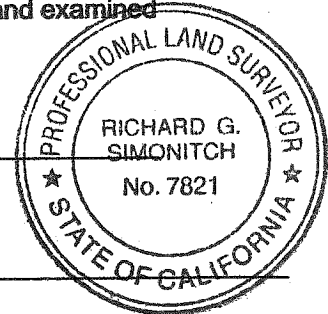

County Surveyor's Comments _____

Broadmoor Ave

50' Wide

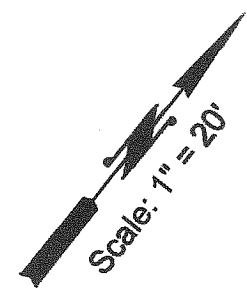

Basis of Bearings
N51°29'00"E 387.00' Record - 387.07 Measured

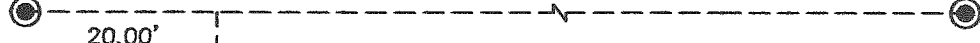

20.00'

N38°31'00"W
25.00'

N51°29'00"E
50.00'

Set 3/4" Iron Pipe
And Tag LS 4397

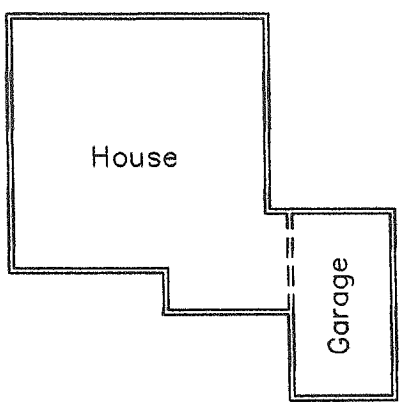

House

Garage

Legend

- Property Line
- Set Mon. as Noted
- Found Street Monument Per 5 RM 35

Lot 46
5 Maps 35

Lot 48
5 Maps 35

Lot 47
5 Maps 35

Lot 39
5 Maps 35

Lot 67
5 Maps 35

N38°31'00"W 100.00'

S38°31'00"E 100.00'

Set Tag LS 4397
In Lower Wood
Fence Runner

S51°29'00"W
50.00'

Cole Residence
84 Broadmoor Ave
San Anselmo, CA
APN 166-220-10

Corner Record

Property Survey
Lot 47, 5 RM 35
Marin County Records