

CORNER RECORD

COUNTY OF _____ T. _____ R. _____ MERIDIAN _____ CALIFORNIA _____
 CORNER TYPE: GOVT. CORNER MEANDER RANCHO CONTROL OTHER
 CORNER IDENTIFICATION — DATE OF VISIT _____ 19____

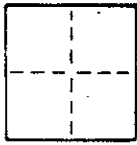

AP # Book 200 Page 19

CORNER — LEFT AS FOUND FOUND AND TAGGED REESTABLISHED OBLITERATED CORNER REBUILT

PHYSICAL DESCRIPTION OF CORNER FOUND; EVIDENCE AND METHOD USED TO IDENTIFY OR REESTABLISH
 Brass Tablet, 3½" diam., cemented into concrete bridge deck on the easterly side of Alexander Ave.

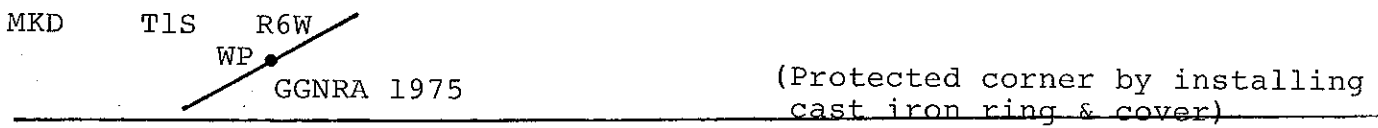

PHYSICAL DESCRIPTION OF MONUMENTS REBUILT OR PERPETUATED
 Set Bronze Disk stamped R.C.E. 18599 set in concrete curb, on Westside of Alexander Ave.

CALIFORNIA COORDINATE SYSTEM ORDER: FIRST SECOND THIRD
 STATIONS USED: NGS (USC & GS) STATE COUNTY OTHER STATION _____ STATION _____
 ZONE _____ ELEVATION _____ NORTHINGS (Y) _____ EASTINGS (X) _____

SKETCH: (Include reference tie or witness points, remarks and topo of area)

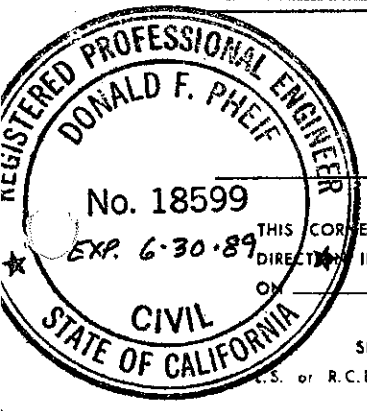
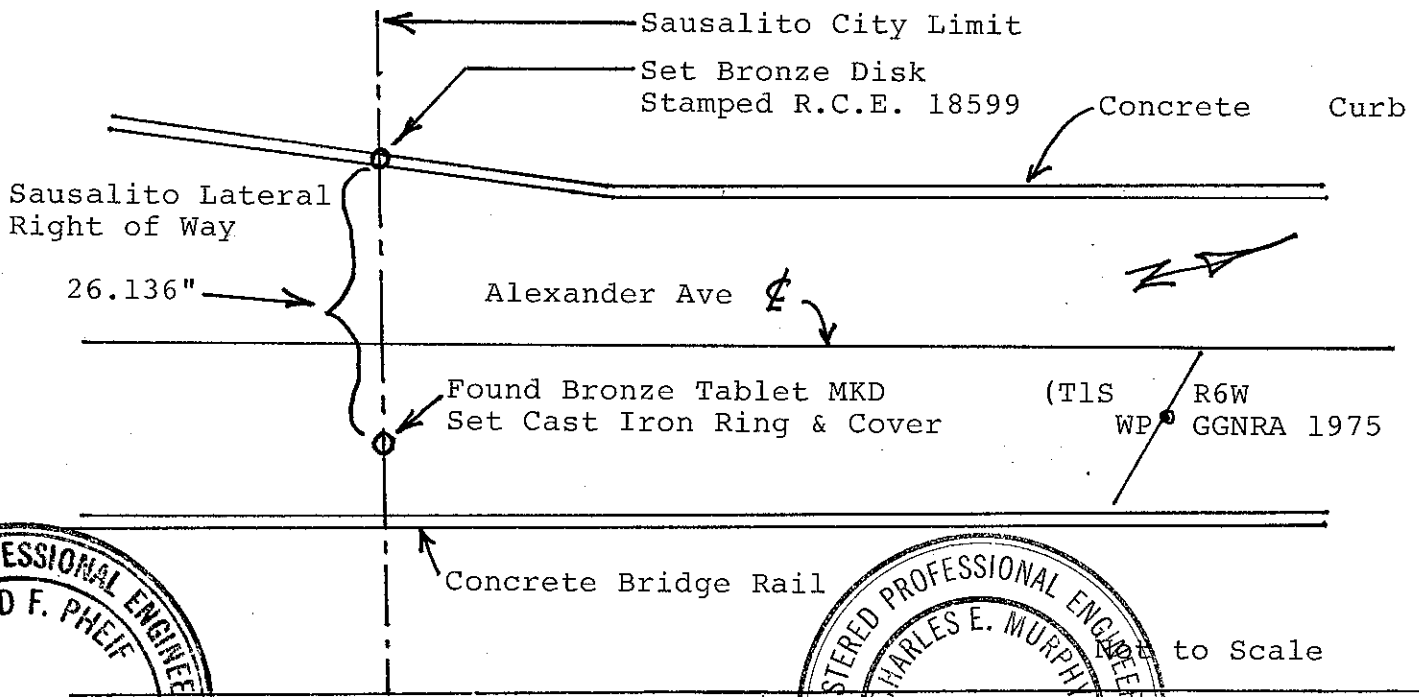

SURVEYOR'S CERTIFICATE
 THIS CORNER RECORD WAS PREPARED BY ME OR UNDER MY DIRECT IN CONFORMANCE WITH THE LAND SURVEYORS ACT
 APRIL 28 19 86
 SIGNED: Donald F. Pfeif
 R.C.E. No.: RCE 18599

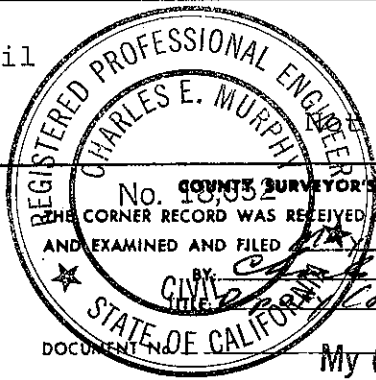

to Scale
 COUNTY SURVEYOR'S CERTIFICATE
 THE CORNER RECORD WAS RECEIVED May 13 1986
 AND EXAMINED AND FILED May 15 1986
 BY Charles E. Murphy
 CIVIL COUNTY SURVEYOR
 My Certificate Expires June 30, 1989