

CORNER RECORD

Muir Beach
County of Marin, California

Document Number APN 199-234-20

Brief Legal Description: Parcel 2, "Parcel Map Lands of Schofield and Harlow Lot 29 through 37, Map of Bello Beach, in the County of Marin, State of California" Recorded Book 6 PM Page 67, Marin County Records.

CORNER TYPE

COORDINATES

Government Corner
Meander
Rancho
Date of Survey : June 7, 2015

Control
Property
Other

(Optional)
N. _____
E. _____
Zone _____ Datum _____
Elev. _____

Corner --Left as found Found and tagged Established Reestablished Rebuilt

Identification and type of corner found: Evidence used to identify or procedure used to establish or reestablish the corner.

This survey is based upon found monuments shown on that certain Corner Record filed under APN 199-234-10, on December 14, 2010, Marin County Records.

A Description of the physical condition of the monument as found and as set or reset.

See Sheet two.

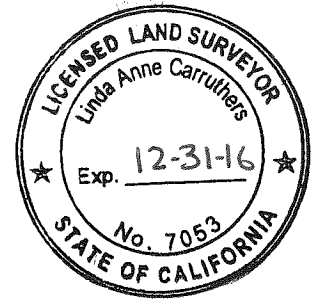

SURVEYOR'S STATEMENT

This Corner Record was prepared by me or under my direction in conformance with the Professional Land Surveyor's Act on July 8, 2015

Signed Linda A. Carruthers P.L.S. 7053

COUNTY SURVEYOR'S STATEMENT

This Corner Record was received JULY 10, 2015, 2015 and examined and filed OCTOBER 15, 2015.

Signed Richard G. Simonitch Title County Surveyor



County Surveyor's Comments _____

