

# CORNER RECORD

Document Number 180-031-06

City of Santa Venetia

County of MARIN, California

Brief Legal Description Record of Survey Mabry Way and western portion  
of Vendula Drive D.P.W. MARIN County 16 R.S. 91.

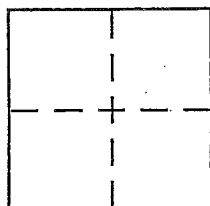

## CORNER TYPE

Government Corner ☐ Control ☒  
Meander ☐ Property ☐  
Rancho ☐ Other ☐  
Date of Survey \_\_\_\_\_

## COORDINATES (Optional)

N. \_\_\_\_\_  
E. \_\_\_\_\_  
Zone \_\_\_\_\_ NAD27 ☐ NAD83 ☐  
NAD83 Epoch \_\_\_\_\_  
Elev. \_\_\_\_\_  
Vert. Datum: NGVD29 ☐ NAVD88 ☐  
Meas. Units: Metric ☐ Imperial ☐

Corner - Left as found ☐ Found and tagged ☐ Established ☐ Reestablished ☐ Rebuilt ☐

Identification and type of corner found: Evidence used to identify or procedure used to establish or reestablish the corner:

Railroad Spike on Mabry Way at the intersection of  
Rafael way. was referenced out prior to paving  
and later re-set.

A description of the physical condition of the monument as found and as set or reset: Re-Set with  
County of Marin Rail and Shiner.

## SURVEYOR'S STATEMENT

This Corner Record was prepared by me or under my direction in conformance with  
the Land Surveyor's Act on 12/30 2014

Signed Michael C. Brogan P.L.S. or R.C.E. No. LS 5767

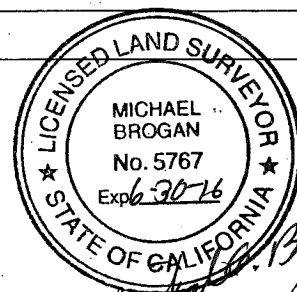

## COUNTY SURVEYOR'S STATEMENT

This Corner Record was received JANUARY 5, 2015  
and examined and filed MARCH 18, 2015

Signed Richard G. Simonitch P.L.S. or R.C.E. No. 7821

Title Deputy

County Surveyor's Comment \_\_\_\_\_

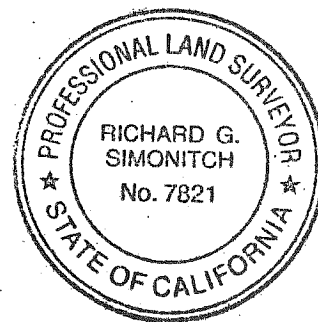

16 RS 91

VENETIA HARBOR  
UNIT TWO  
7 MAPS 5

A.P.N.  
180-031-06

SEE SHEET 4

RAILROAD SPIKE RESET WITH  
COUNTY NAIL AND SHINER

RAFAEL WAY

L = 297.08'  
(CALC. FROM 7 MAPS 5 AND HELD)

$\Delta = 6^{\circ}08'39''$

L = 215.01' (214.98)

A.P.N.  
180-033-03

N 42° 00' 06" W (R)

L = 230.19'

44.50'

210.00'

S 46° 43' 30" W  
5.00'

MABRY WAY

120.03'

(RADIAL)

120.03'

LEGEND

- FOUND IRON PIPE OR AS NOTED
- △ SET RR SPIKE
- ⊙ SET STANDARD COUNTY MONUMENT
- ( ) RECORD INFORMATION

COUNTY OF MARIN  
DEPARTMENT OF PUBLIC WORKS  
SURVEY SECTION

SCALE: 1" = 30'

CORNER RECORD