

CORNER RECORD

Documented Number **179-331-02**

City of **SAN RAFAEL**

County of **MARIN**, California

Brief Legal Description **LOT 2, PORTOLA ESTATES, UNIT ONE, 11 RM 18**

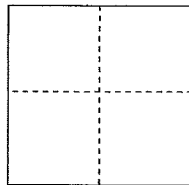

CORNER TYPE

Government Corner ☐ Control ☐
Meander ☐ **Property** ☒
Rancho ☐ Other ☐

COORDINATES(Optional)

N. _____
E. _____
Zone _____ NAD27 ☐ NAD83 ☐
NAD83 Epoch _____
Elevation _____
Vert. Datum: NGVD 29 ☐ NADV88 ☐
Meas. Units: Metric ☐ Imperial ☐

Date of Survey **1/28/2016**

Corner- Left as found ☐ Found and tagged ☐ Established ☐ Reestablished ☒ Rebuilt ☐

Identification and type of corner found: Evidence used to identify or procedure used to establish or reestablish the corner:

**REESTABLISH THE SOUTHWESTERLY CORNER OF LOT 2, MAP OF PORTOLA ESTATES, UNIT ONE, 11 RM 18, FROM STANDARD STREET MONUMENTS PER RECORD MAP ON CARMEL COURT.
SEE SKETCH ON REVERSE SIDE FOR DETAILS.**

A description of the physical condition of the monument as found and as set or reset: **SET ONE HALF INCH REBAR WITH YELLOW PLASTIC CAP ATTACHED TO THE TOP OF THE REBAR AND DRIVEN FLUSH TO THE SURROUNDING GRADE. THE CAP IS STAMPED "SCRANTON, PLS 5379".**

SURVEYOR'S STATEMENT

This Corner Record was prepared by me or under my direction in conformance with

the Land Surveyor's Act on **FEBRUARY 2, 2016**

Signed

Douglas J. Scranton

P.L.S. or R.C.E. No.:

PLS 5379

COUNTY SURVEYOR'S STATEMENT

This Corner Record was received

FEBRUARY 8, 2016

and examined

and filed

MAY 13, 2016

Signed

Richard G. Simonitch

P.L.S. or R.C.E. No.:

7821

Title

County Surveyor

County Surveyor's Comment

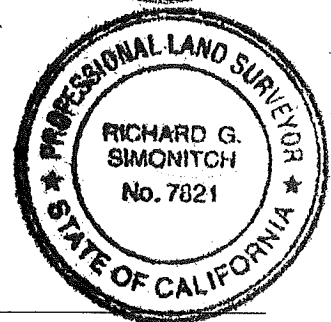
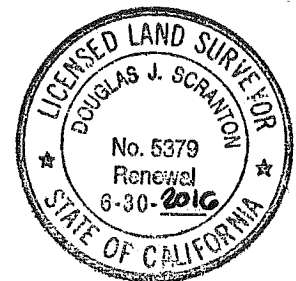

SCALE : 1" = 20'



(HELD POSITION)
STREET MONUMENT
PIN WITH TAG IN
CONCRETE.

N82°30'00"E 25.00'

R=20'

REMAINDER NOT DEPICTED

CARMEL COURT (50')

S07°30'00"E
96.00'

11 RM 18
PORTOLA ESTATES
UNIT ONE
LOT 2

11 RM 18
PORTOLA ESTATES
UNIT ONE

(LOT 3)

(S07°30'00"E)
(92.40')

EXISTING REBAR WITH
LS 3887 CAP AT LOT CORNER
(SEE CORNER RECORD BY
JERRICO ASSOCIATES FOR APN
179-331-02 FILED 10/6/1998)

S82°30'00"W
73.00'

11 RM 18
PORTOLA ESTATES
UNIT ONE
(LOT 1)

N40°55'20"W
43.52'

EXISTING 1/2" REBAR WITH
PLS 5379 CAP PER MARIN
COUNTY CORNER RECORD
FOR APN 179-331-03 BY THIS
OFFICE FILED 9/21/2001

S78°30'00"E
41.50'

LOT 53
(6 MAPS 89)

STREET MONUMENT AT
GARDEN AVENUE & CARMEL COURT. PIN
WITH TAG IN CONCRETE.

LEGEND

NO EASEMENTS ARE SHOWN

ALL DISTANCES GIVEN IN FEET
AND DECIMALS THEREOF

- SET 1/2" REBAR WITH YELLOW
PLASTIC CAP ATTACHED TO TOP
STAMPED "SCRANTON PLS 5379 "
● FOUND SURVEY MARKER AS NOTED

BASIS OF BEARINGS

TAKEN AS SOUTH 07°30'00"EAST
BETWEEN STREET MONUMENTS
ON CARMEL COURT AS SHOWN
HEREON AND AS SAID MONUMENTS
ARE SHOWN UPON 11 RM 18