

CORNER RECORD

Agency Index CR 22-118
Document Number APN 176-102-01

City of SAN ANSELMO County of MARIN, California
Brief Legal Description 30 GARDEN ROCK ROAD - LOT 7, (8M37)

CORNER TYPE

COORDINATES (Optional)

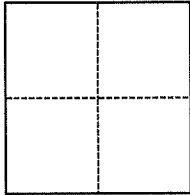

- ☐ Government Corner ☐ Control
☐ Meander ☒ Property
☐ Rancho ☐ Other

Date of Survey January 29, 2021

N. _____ E. _____
Elevation _____
Units ☐ Metric ☒ U.S. Survey Foot
Horizontal Datum _____
Zone _____ Epoch Date _____
Vertical Datum _____
☐ Complies with Public Resources Code §§8801-8819
☐ Complies with Public Resources Code §§8890-8902

PLS Act Ref.: ☒ 8765(d) ☐ 8771 ☐ 8773 ☐ Other:
Corner/
Monument: ☐ Left as found ☒ Established ☐ Rebuilt ☐ Pre-Construction
☐ Found and tagged ☐ Reestablished ☐ Referenced ☐ Post-Construction

Narrative of corner identified and monument as found, set, reset, replaced, or removed:

☒ See sheet #2 for description(s):

SURVEYOR'S STATEMENT

This Corner Record was prepared by me or under my direction in conformance with

the Professional Land Surveyors' Act on August 26, 2022

Signed [Signature] P.L.S. or R.C.E. No. 5254

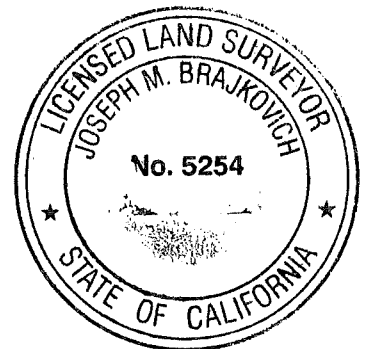

COUNTY SURVEYOR'S STATEMENT

This Corner Record was received January 23, 2023

and examined and filed January 25, 2023

Signed T. L. D. [Signature] P.L.S. [Redacted] No. 8176

Title County Surveyor

County Surveyor's Comment



