

L. A. Stevens & Associates, Inc.
Professional Land Surveyors
Novato, California

Lands of Mackenzie
Job #: 12-1415

CORNER RECORD

Document Number 160-960-13

City of Novato, County of Marin, California

Brief Legal Description: Being lot 272 of that certain map entitled Map of Pointe Marin Phase Three, recorded in Book 2003 of Maps at Page 180.

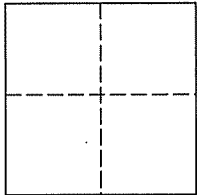

CORNER TYPE

COORDINATES (Optional)

Government Corner Control

Meander Property

Rancho Other

Date of Survey October 4, 2012

N _____

E _____

Zone _____ NAD27 NAD83

NAD 83 Epoch _____

Elev. _____

Vert. Datum: NGVD29 NAVD88

Meas. Units: Metric Imperial

Corner - Left as found Found and tagged Established Reestablished Rebuilt

Identification and type of corner found: Evidence used to identify or procedure used to establish or reestablish the corner:
See Page 2 of 2

A description of the physical condition of the monument as found and as set or reset:
See Page 2 of 2

SURVEYOR'S STATEMENT

This Corner Record was prepared by me or under my direction in conformance with

The Land Surveyor's Act on October 17, 2012

Signed [Signature] P.L.S. 6649



COUNTY SURVEYOR'S STATEMENT

This Corner Record was received OCTOBER 19, 2012

and examined and filed NOVEMBER 27, 2012

Signed [Signature] P.L.S. or R.C.E. No. 7128

Title COUNTY SURVEYOR

County Surveyors' Comment _____



All distances shown are in feet and decimals thereof

()1 = Record data per 2003 RM 180

GRAPHIC SCALE

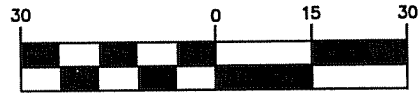

(IN FEET)

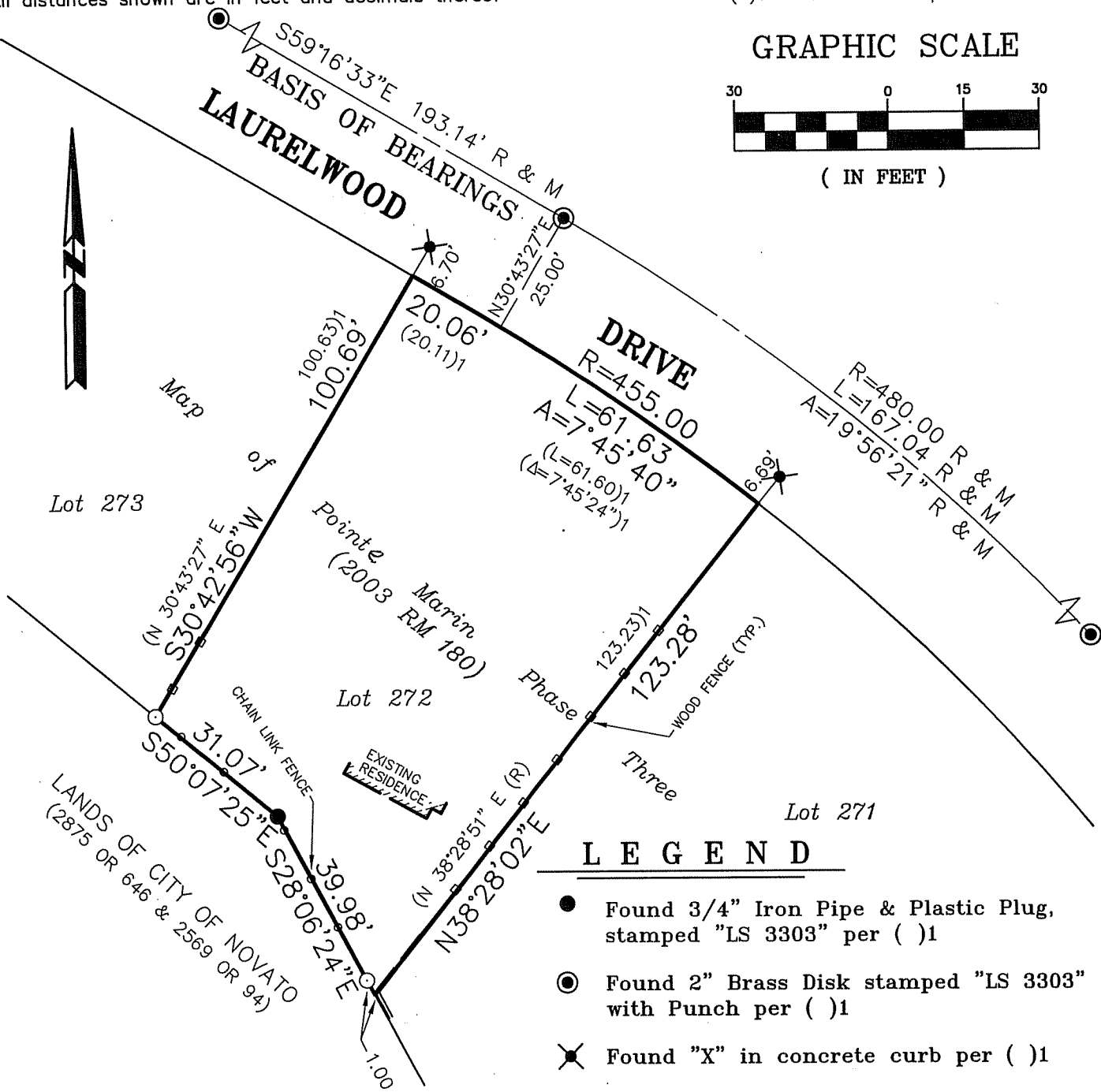

LEGEND

- Found 3/4" Iron Pipe & Plastic Plug, stamped "LS 3303" per ()1
- ⊙ Found 2" Brass Disk stamped "LS 3303" with Punch per ()1
- ✕ Found "X" in concrete curb per ()1
- Set 3/4" Iron Pipe & Plastic Plug, Stamped "L.A. Stevens, LS 6649"

R & M Record & Measured

Corner Record Lands of Mackenzie

(Lot 272, 2003 RM 180)

Novato Marin County California
 Scale: 1" = 30' October 2012

L.A. Stevens & Associates, Inc.

Professional Land Surveyors * (415) 382-7713
 7 Commercial Blvd., Suite 1 * Novato, CA 94949

Job # 121415

Page 2 Of 2



Lawrence A. Stevens, PLS 6649