

# CORNER RECORD

Documented Number 140-082-42

City of Novato

County of Marin, California

Brief Legal Description Lot 8 Map of Margory Court 14 Maps 82 Marin County Records

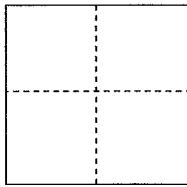

### CORNER TYPE

Government Corner  Control   
Meander  Property   
Rancho  Other

### COORDINATES(Optional)

N. \_\_\_\_\_  
E. \_\_\_\_\_  
Zone \_\_\_\_\_ NAD27  NAD83   
NAD83 Epoch \_\_\_\_\_  
Elevation \_\_\_\_\_  
Vert. Datum: NGVD 29  NADV88   
Meas. Units: Metric  Imperial

Date of Survey April 17, 2013

Corner- Left as found  Found and tagged  Established  Reestablished  Rebuilt

Identification and type of corner found: Evidence used to identify or procedure used to establish or reestablish the corner:

**Reestablish a portion of the Southerly line of Lot 8, Map of Margory Court, 14 Maps 82.**  
**Refer to previous work done by this office for the Northerly and Easterly line of same said Lot 8 depicted on the Marin County Corner Record filed August 4, 2011 for APN 140-082-42.**  
**See sketch on reverse side for details.**

A description of the physical condition of the monument as found and as set or reset:

**Set brass nail with brass tag stamped LS 5379 on a prolongation of the said Southerly line onto the top of curb of Margory Court and also set one half inch rebar with PLS cap affixed to top of rebar and driven flush to surrounding grade at a random interval on said Southerly line. Cap is stamped "Scranton, PLS 5379". See sketch on reverse side for details.**

### SURVEYOR'S STATEMENT

This Corner Record was prepared by me or under my direction in conformance with

the Land Surveyor's Act on May 31, 2013

Signed Douglas J. Scranton P.L.S. or R.C.E. No.: PLS 5379

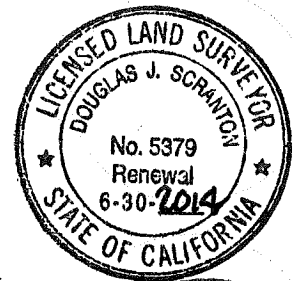

### COUNTY SURVEYOR'S STATEMENT

This Corner Record was received JUNE 13, 2013 and examined

and filed July 17 2013

Signed Richard G. Simonitch P.L.S. or R.C.E. No.: 7821



Title DEPUTY CO. SURVEYOR

County Surveyor's Comment \_\_\_\_\_



MARGORY COURT (40')

BASIS OF BEARINGS

N29°15'00"E (250.00', R1)  
250.06', MEAS.

N27°35'18"E 238.02'  
N27°33'49"E 238.03', MEAS.

R1 MAP CALC.

R1 MAP CALC.

S43°57'15"E  
32.61'

N72°32'59"E  
31.49'

N81°41'12"E 125.00'

112.57'

87.78'

N29°15'00"E 98.51'

13.26'

82.21'

28.29'

6.00'

6.00'

NOTE:  
MONUMENT PIN IN CONCRETE  
CYLINDER IS SHEARED OFF BUT  
PIN POSITION IS STILL VISIBLE.  
PIN POSITION IS S40°E, ±0.04'  
FROM THE CENTER OF THE  
CONCRETE CYLINDER

ON PROPERTY LINE PROJECTED  
ON PROPERTY LINE  
ON PROPERTY LINE PROJECTED  
ON PROPERTY LINE PROJECTED

LOT 7

LOT 8  
MAP OF MARGORY COURT  
14 MAPS 82

LOT 9

**LEGEND**

- STANDARD STREET MONUMENT PER R1 ( CONCRETE CYLINDER WITH SMALL PIN )
- EXISTING 1/2" REBAR WITH PLASTIC CAP EMBOSSED "PLS 5379 SCRANTON" ATTACHED TO TOP OF REBAR PER PREVIOUS CORNER RECORD FOR APN 140-082-44
- EXISTING BRASS NAIL WITH BRASS TAG LS 5379 PER PREVIOUS CORNER RECORD FOR APN 140-082-44
- SET 1/2" REBAR WITH PLASTIC CAP EMBOSSED "PLS 5379 SCRANTON" ATTACHED TO TOP OF REBAR
- ⊙ SET BRASS NAIL WITH BRASS TAG STAMPED LS 5379 IN CONCRETE (TOP OF CURB)
- R1 14 MAPS 82

**BASIS OF BEARINGS**

TAKEN AS NORTH 29°15'00" EAST BETWEEN MONUMENTS ON MARGORY COURT AS SHOWN HEREON AND AS SAID MONUMENTS ARE SHOWN UPON R1

ALL DIMENSIONS GIVEN IN FEET AND DECIMALS THEREOF

NO EASEMENTS ARE SHOWN