

CORNER RECORD

Document Number 132-104-31

City of Novato County of Marin, California

Brief Legal Description Parcel 2 as depicted upon 18 PM 1, MCR

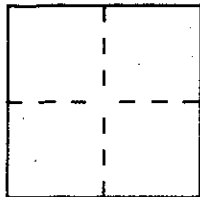

CORNER TYPE

Government Corner Control
 Meander Property
 Rancho Other
 Date of Survey April 18, 2000

COORDINATES (Optional)

N. _____
 E. _____
 Zone _____ Datum _____
 Elev. _____

Corner — Left as found Found and tagged Established Reestablished Rebuilt

Identification and type of corner found: Evidence used to identify or procedure used to establish or reestablish the corner:
Reestablish the angle point in the Southerly line of Parcel two of
18 PM 1; being the intersection of the two courses N 61° 05' W, 86.418'
and N 83° 30' W, 128.00 feet; said angle point set from existing
Standard Street monuments on Lobo Vista that are depicted upon said
Parcel Map of Record; refer to sketch on reverse side for further details.

A description of the physical condition of the monument as found and as set or reset:
Set one half inch rebar with PLS plastic cap embossed with
"Scranton, PLS 5379 on top of cap and cap affixed to top of rebar and
driven flush with surrounding grade at ground level.

SURVEYOR'S STATEMENT

This Corner Record was prepared by me or under my direction in conformance with
 the Land Surveyors Act on May 10th ~~19~~ 2000
 Signed *Douglas J. Scranton* L.S. or R.C.E. Number PLS 5379
renewal 6/30/00

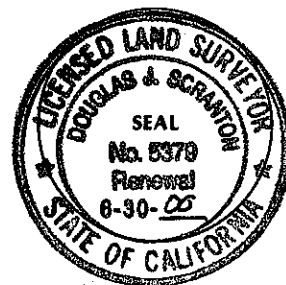

COUNTY SURVEYOR'S STATEMENT

This Corner Record was received 5-12-2000 19 and examined
 and filed 5-15-2000 19
 Signed *John M. Woolley* Title DEPUTY

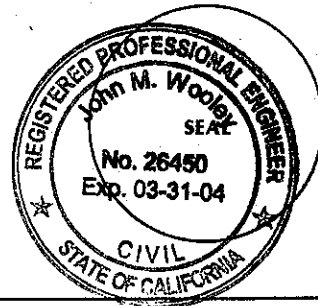

County Surveyor's Comment _____

(415) 897-2663

NOVATO, CA 94945

PREPARED BY: SCRANTON SURVEYING 845 OLIVE AVE. SUITE 203

(REMAINDER NOT DEPICTED)

SITES: 125 LDBO MSTA
MONARCH, CA
(APN 132-104-31)

THIS CORNER RECORD
SET 1/2" REBAR WITH
PIG CAP 5373

PARCEL 2
18 PM 1

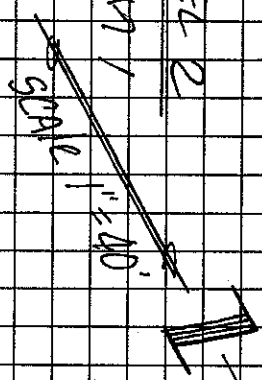

(TYPICAL)

EXISTING
STANDARD STREET
MONUMENT

SOUTH 30°36' EAST
MONUMENT "BASIS OF BEARING"

86.418' N 61°05' W
128.0' N 83°30' E

NOTE: FOUND 453771 @ LOT CORNER
(ORIGINAL PARCEL MAP PIPE)

(PARCEL 2) N 28°55' E
(PARCEL 1) 170.00'

(PARCEL 1)
18 PM 1

ROSEMENTS ARE NOT DEPICTED

N 13°49' 44" E
65.841'

