

CORNER RECORD

Document Number 112-296-22

City of Inverness

County of Marin, California

Brief Legal Description Control Point for Various Maps, Inverness

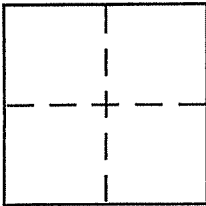

CORNER TYPE

- Government Corner Control
- Meander Property
- Rancho Other
- Date of Survey _____

COORDINATES (Optional)

N. _____
 E. _____
 Zone _____ NAD27 NAD83
 NAD83 Epoch _____
 Elev. _____
 Vert. Datum: NGVD29 NAVD88
 Meas. Units: Metric Imperial

Corner - Left as found Found and tagged Established Reestablished Rebuilt

Identification and type of corner found: Evidence used to identify or procedure used to establish or reestablish the corner:
Railroad Spike @ S'ly end of a control line on Sir Francis Drake Blvd through downtown Inverness. SFD was repaved in 2007. Spike referenced out, reestablished per reference points and Rebuilt as a Standard County Monument

A description of the physical condition of the monument as found and as set or reset: See Back

SURVEYOR'S STATEMENT

This Corner Record was prepared by me or under my direction in conformance with the Land Surveyor's Act on June 9, 2008
 Signed Michael G. Brogan P.L.S or R.C.E. No. LS 5767
Chief of Surveys - DPW

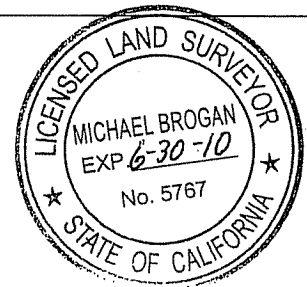

COUNTY SURVEYOR'S STATEMENT

This Corner Record was received JUNE 11, 2008
 and examined and filed JUNE 26, 2008
 Signed _____ P.L.S or R.C.E. No. 7128
 Title COUNTY SURVEYOR



County Surveyor's Comment _____

61

59 = FOUND RR SPIKE, SET BY 19 DS 40, AND REFERENCED OUT IN 2007 PRIOR TO REPAVING REPLACED WITH STANDARD COUNTY MONUMENT

61 = FOUND COUNTY MONUMENT. CO. DRAWING 40-55 FOUND NAIL OVER IRON PIPE, 1942. 3 P.M. 41 SET A NAIL, 1968. 19 D.S. 40 FOUND BENT RR SPIKE, SET A NAIL, 1984, 36 D.S. 92 FOUND COUNTY MONUMENT.

62 - 65 = REFERENCE POINTS AS NOTED.

62 = 'X' CUT END CURB IN ISLAND

63 = 'X' CUT CONCRETE MANHOLE FOUNDATION

64 = 'X' CUT ON WIDE CURB

65 = SET 'PK' NAIL IN ASPHALT DRIVEWAY

SIR FRANCIS DRAKE BLVD.
IN INVERNESS

LOTS 1 THRU 6, BLOCK 17, 1 RM 80.
SEE 19 DS 40, AND 22 D.S. 35

433.70
N23°54'00"W
432.65'
19 DS 40

BASIS OF BEARINGS

APN 112-296-22



SCALE: 1" = 40'

