

CORNER RECORD

Document Number APN 075-172-01
County of Marin, California

Brief Legal Description: Portion of Lot 430 "Map of Kent Woodlands Subd. No. Twelve, in the County of Marin, California" recorded in Book 8 Record Maps, Page 91, Marin County Records.

CORNER TYPE

Government Corner Control
Meander Property
Rancho Other
Date of Survey March 26, 2001

**COORDINATES
(Optional)**

N. _____
E. _____
Zone _____ Datum _____
Elev. _____

Corner --Left as found Found and tagged Established Reestablished Rebuilt

Identification and type of corner found: Evidence used to identify or procedure used to establish or reestablish the corner.

This survey is based upon found monuments shown on that certain map entitled " Map of Kent Woodlands Subd. No. Twelve, in the County of Marin, California" recorded in Book 8 Record Maps, Page 91, Marin County Records.

A Description of the physical condition of the monument as found and as set or reset.

See Sheet two.

SURVEYOR'S STATEMENT

This Corner Record was prepared by me or under my direction in conformance with the Land Surveyor's Act on April 10, 2001.

Signed *Linda Anne Carruthers* P.L.S. 7053

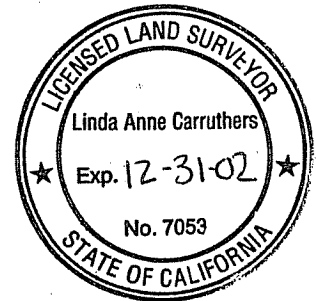

COUNTY SURVEYOR'S STATEMENT

This Corner Record was received MAY 14, 2001 and examined and filed MAY 17, 2001.

Signed *Craig Tackabery* Title DEPUTY



County Surveyor's Comments _____



FD 1/2" IP/CAP
LS 3775

N 13°40'00" W
49.97

165.00
55.48

FD 3/4" IP/TACK

LEGEND

- ⊙ FD STEEL PIN/WASHER IN STD. WELL MONUMENT
- ⊙ FD IRON PIPE AS NOTED (NO RECORD)
- SET 5/8" RB AND CAP. PLS 7053

LOT 430
8 RM 91

N 27°49'28" E 160.37'
CALC. RECORD TIE 8 RM 91

ROAD

257.23'

N 19°11'00" W

PHOENIX ROAD

CROWN

PARTIAL BOUNDARY SURVEY
147 CROWN ROAD, KENTFIELD
APN 075-172-01

CARRUTHERS LAND SURVEYING
P.O. BOX 6248 SAN RAFAEL, CA
(415) 388-2438

SCALE 1"=60' DATE MARCH, 2001
JOB NO. 00-330 SHEET 2 OF 2