

CORNER RECORD

Document Number A.P. 075-121-18

City of KENTFIELD

County of MARIN, California

Brief Legal Description PARCEL 2 PER 3 P.M. 10, LOT 324 PER 7 R.M. 43

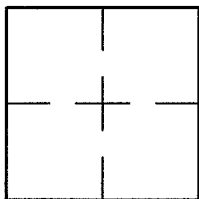

CORNER TYPE

COORDINATES (Optional)

Government Corner  Control

Meander  Property

Rancho  Other

Date of Survey 6/17/14

N. \_\_\_\_\_  
 E. \_\_\_\_\_  
 Zone \_\_\_\_\_ NAD27  NAD83   
 NAD83 Epoch \_\_\_\_\_  
 Elev. \_\_\_\_\_  
 Vert. Datum: NGVD29  NAVD88   
 Meas. Units: Metric  Imperial

Corner- Left as found  Found and tagged  Established  Reestablished  Rebuilt

Identification and type of corner found: Evidence used to identify or procedure used to establish or reestablish the corner:

REESTABLISHED THE COMMON LINE BETWEEN LOTS 323 AND 324 USING MONUMENTS ON FERN WAY PER 7 R.M. 43 AND AS SHOWN ON SHEET 2.

A description of the physical condition of the monument as found and as set or reset: SEE SHEET 2.

SURVEYOR'S STATEMENT

This Corner Record was prepared by me or under my direction in conformance with

the Land Surveyor's Act on JUNE 23, 2014

Signed Lawrence P Doyle P.L.S. or R.C.E. No. P.L.S. 4694

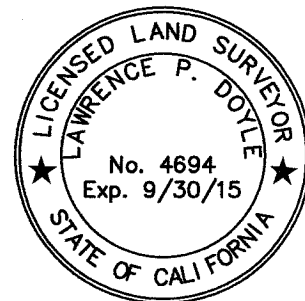

COUNTY SURVEYOR'S STATEMENT

This Corner Record was received JULY 1, 2015

and examined and filed OCTOBER 28, 2015

Signed Richard G. Simonitch P.L.S. or R.C.E. No. 7821

Title County Surveyor



County Surveyor's Comment \_\_\_\_\_

FOUND 2" PIPE  
IN 2010

" BASIS OF BEARING  
S36°08'00"E  
182.12'

FOUND 2" PIPE/TAG  
UNDER ASPHALT

20.00'

FERN WAY  
40' R/W

Δ=20°07'00"  
L=112.35'  
R=320.00'

LOT 323  
7 R.M. 43

SET NAIL IN CONCRETE  
IT MAY BE THE OLD  
CONC. MON PER 3 P.M.  
IT LOOKS LIKE IT GOT  
SMASHED BY WORKERS  
DIGGING A TRENCH

32

S55°48'30"W  
34.08'

SET PIPE/PLUG  
L.S. 4694

S85°39'40"W  
79.81'

SET PIPE/PLUG  
L.S. 4694

35.85'  
21.29'

S56°15'00"E

N64°04'00"W

LOT 324  
7 R.M. 43  
PARCEL 2  
3 P.M. 10



CORNER RECORD  
A.P. 075-121-18  
MARIN COUNTY CALIFORNIA

LAWRENCE P. DOYLE  
LAND SURVEYOR/CIVIL ENGINEER

SCALE: 1" = 40'  
DATE: 6/23/14  
100 HELENS LANE MILL VALLEY CA 94941 (415-388-9585)

DRAWN BY:  
SHEET 2 OF 2  
DRAWING NO.  
2017