

AP# 074-192-15

# CORNER RECORD

Document Number 2010-034400

City of KENTFIELD

County of MARIN, California

Brief Legal Description LOT 290, 6-RM-36b

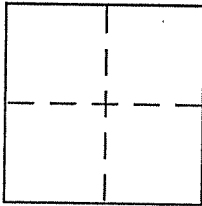

### CORNER TYPE

Government Corner  Control   
 Meander  Property   
 Rancho  Other   
 Date of Survey \_\_\_\_\_

### COORDINATES (Optional)

N. \_\_\_\_\_  
 E. \_\_\_\_\_  
 Zone \_\_\_\_\_ NAD27  NAD83   
 NAD83 Epoch \_\_\_\_\_  
 Elev. \_\_\_\_\_  
 Vert. Datum: NGVD29  NAVD88   
 Meas. Units: Metric  Imperial

Corner -- Left as found  Found and tagged  Established  Reestablished  Rebuilt

Identification and type of corner found: Evidence used to identify or procedure used to establish or reestablish the corner:

SEE PAGE 2

A description of the physical condition of the monument as found and as set or reset:

SEE PAGE 2

### SURVEYOR'S STATEMENT

This Corner Record was prepared by me or under my direction in conformance with the Land Surveyor's Act on 11/18/11

Signed William Schroeder P.L.S. or R.C.E. No. 5814

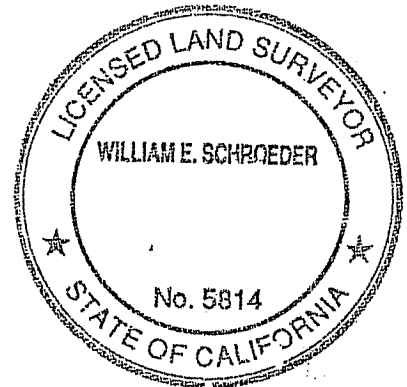

### COUNTY SURVEYOR'S STATEMENT

This Corner Record was received NOVEMBER 21, 2011

and examined and filed JANUARY 25, 2012

Signed [Signature] P.L.S. or R.C.E. No. 7128

Title COUNTY SURVEYOR

County Surveyor's Comment \_\_\_\_\_

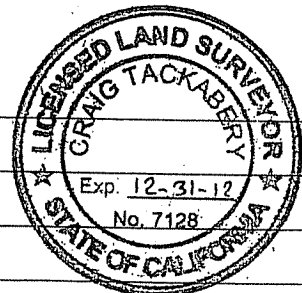

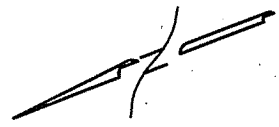

SCALE: 1" = 90'

TREE TOP WAY

N37°16'46"E  
44.49

N66°26'00"E  
51.75

L=65.34'  
D=93°35'17"  
R=40.00

LOT 289

R M 36

LOT 291

LANDS OF BRONSTEIN  
DN 2010-034400

LOT 290

S50°30'01"E 129.59

N25°41'00"W  
128.57

Fd 3/4" Iron Pipe  
"RCE 12510"

M<sub>100</sub>LS<sub>57</sub>LN  
N74°37'00"  
34.20  
02.76

Fd 3/4" Iron Pipe  
"RCE 12510"

Set 3/4" Iron Pipe  
"LS 5814"  
32.32

Set 3/4" Iron Pipe  
"LS 5814"  
33.76

Set 3/4" Iron Pipe  
"LS 5814"

N20°46'00"E  
85.30

L=25.48'  
D=11°40'40"  
R=125.00

N09°07'00"E  
29.79

L=66.08'  
D=11°39'00"  
R=325.00

CROWN ROAD

