

CORNER RECORD

Document Number APN 074-112-06

City of Kentfield

County of Marin, California

Brief Legal Description Lot 13 - Map of Kentfield Gardens, Book 7 Rm Page 7.

APN 074-112-06

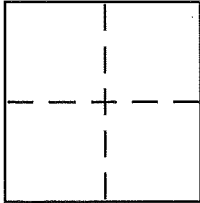

CORNER TYPE

Government Corner Control
Meander Property
Rancho Other
Date of Survey July 23, 2013

COORDINATES (Optional)

N. _____
E. _____
Zone _____ NAD27 NAD83
NAD83 Epoch _____
Elev. _____
Vert. Datum: NGVD29 NAVD88
Meas. Units: Metric Imperial

Corner - Left as found Found and tagged Established Reestablished Rebuilt

Identification and type of corner found: Evidence used to identify or procedure used to establish or reestablish the corner:

Found 3/4" Iron Pipe & Plastic Plug (with tack) RCE 30465
Per Book 2003 Maps Page 104 and as shown on Page 2 of 2
this document.

A description of the physical condition of the monument as found and as set or reset:

Set monuments at Record Locations Per Book 7 Rm Page 7,
and as shown on Page 2 of 2 this document.

SURVEYOR'S STATEMENT

This Corner Record was prepared by me or under my direction in conformance with the Land Surveyor's Act on July 23 2013.

Signed Jeffrey G. Dillberg P.L.S or R.C.E. No. 26936

COUNTY SURVEYOR'S STATEMENT

This Corner Record was received AUGUST 13, 2013

and examined and filed SEPTEMBER 9, 2013

Signed Richard G. Simonitch P.L.S or R.C.E. No. 7821

Title DEPUTY CO. SURVEYOR

County Surveyor's Comment _____



Prepared By:
 Horizon Land Surveys, Inc.
 Jeffrey Dillberg, PLS
 2436 Carriage Place
 Napa, California 94558
 707 257 1017 Phone
 707 321 5723 Cell
 JeffDillberg@Gmail.com

Found 3/4" Iron Pipe &
 Plastic Plug (With Tack)
 RCE 30465
 Per Book 2003 Maps Page 104
 SN: 2003-48607.



Found 3/4" Iron Pipe &
 Plastic Plug (With Tack)
 RCE 30465
 Per Book 2003 Maps Page 104
 SN: 2003-48607.

NOTE: All Bearings and Distance shown
 hereon are Record and Measured.

Set 3/8" Rebar &
 Brass Tag PLS 6936

Set 8" HubNail &
 Brass Tag PLS 6936

Set 8" HubNail &
 Brass Tag PLS 6936

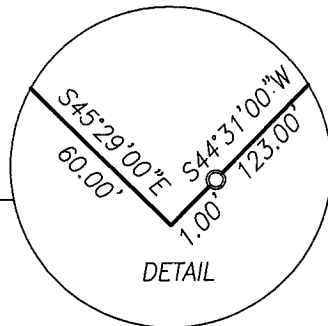

SCALE 1 Inch = 30 Feet