

CORNER RECORD

Document Number 70-011-05 & 04

City of (GREENBRAE)

County of MARIN, California

Brief Legal Description LOTS 529 & 530, GREENBRAE, SUB C, 7 MAPS 92

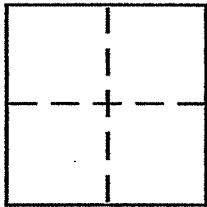

CORNER TYPE

Government Corner Control
Meander Property
Rancho Other
Date of Survey 3/29/2011

COORDINATES (Optional)

N. _____
E. _____
Zone _____ NAD27 NAD83
NAD83 Epoch _____
Elev. _____
Vert. Datum: NGVD29 NAVD88
Meas. Units: Metric Imperial

Corner -- Left as found Found and tagged Established Reestablished Rebuilt

Identification and type of corner found: Evidence used to identify or procedure used to establish or reestablish the corner:

REESTABLISH THE SOUTHERLY LINE OF LOT 530 (BEING ALSO THE NORTHERLY LINE OF LOT 529) FROM EXISTING STREET MONUMENTS ON VISTA GRANDE AS DEPICTED UPON THE MAP OF GREENBRAE, SUB C, 7 MAPS 92. SEE REVERSE SIDE FOR DETAILS.

A description of the physical condition of the monument as found and as set or reset:

1) SET MAG NAIL IN PAVEMENT ON LOT LINE PROJECTED & THE CENTERLINE OF VISTA GRANDE 2) SET BRASS NAIL WITH BRASS TAG LS 5379 AT LOCATIONS SHOWN ON REVERSE SIDE 3) SET 1/2" REBAR WITH CAP STAMPED SCRANTON, PLS 5379 AT LOCATIONS SHOWN ON REVERSE SIDE.

SURVEYOR'S STATEMENT

This Corner Record was prepared by me or under my direction in conformance with

the Land Surveyor's Act on APRIL 4 2011

Signed [Signature] P.L.S. or R.C.E. No. PLS 5379

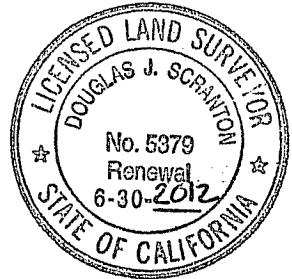

COUNTY SURVEYOR'S STATEMENT

This Corner Record was received APRIL 7, 2011

and examined and filed MAY 9, 2011

Signed [Signature] P.L.S. or R.C.E. No. 7128

Title COUNTY SURVEYOR

County Surveyor's Comment _____



PREPARED BY DJ SCRANTON SURVEYING PETAUMA, CA



VISTA GRANDE (40')

S10°50'00"E 162.49' MEAS.
(162.52', R1)

SEE DETAIL

S10°50'00"E

90.00'

SET ON TOP OF
ROCK WALL

5.54', R1
AND MEAS.

S10°50'00"E

5.54'

12.24'

SET ON CONCRETE CURB

7.76'

CORNER POINT
NOT SET

(LOT 531)

LOT 530

7 MAPS 92
GREENBRAE SUB 6
LOT 530

(LOT 529)

S79°10'00"W
300.00'

87.41'

S79°10'00"W
300.00'

DETAIL

SCALE : 1" = 10'

(LOT 532)

105.02'

58.23'

S10°50'00"E

90.00'

(LOT 522)

LEGEND

- ⊙ STANDARD STREET MONUMENT, R1
- SET 1/2" REBAR/PLS CAP 5379
- ∅ SET BRASS NAIL AND BRASS CAP LS 5379
- △ SET MAG NAIL
- R1 7 MAPS 92

BASIS OF BEARINGS

TAKEN AS SOUTH 10°50'00" EAST BETWEEN MONUMENTS
AS SHOWN ON VISTA GRANDE AND AS SAID MONUMENTS
ARE DEPICTED UPON R1.

NOTES:

NO EASEMENTS ARE SHOWN
ALL DIMENSIONS GIVEN IN
FEET AND DECIMALS THEREOF