

**CORNER RECORD**

City of Sausalito  
County of Marin, California

Vicinity APN 065-264-13 Q

Brief Legal Description: Monument Relocation, M 262 Fourth and Main Street, Sausalito, CA 94966

**CORNER TYPE**

**COORDINATES**

Government Corner   
Meander   
Rancho   
Date of Survey: July 12, 2016

Control   
Property   
Other

*(Optional)*  
N. \_\_\_\_\_  
E. \_\_\_\_\_  
Zone \_\_\_\_\_ Datum \_\_\_\_\_  
Elev. \_\_\_\_\_

Corner --Left as found  Found and tagged  Established  Reestablished  Rebuilt

Identification and type of corner found: Evidence used to identify or procedure used to establish or reestablish the corner.

This survey was conducted to preserve the location of City of Sausalito Monument M 262 at the intersection of Fourth and Main Street. M 262 was destroyed during the construction of a new storm drain and relocated as described on this Corner Record.

A Description of the physical condition of the monument as found and as set or reset.

See Sheet two.



**SURVEYOR'S STATEMENT**

This Corner Record was prepared by me or under my direction in conformance with the Professional Land Surveyor's Act on July 14, 2016 - 11-09-16

Signed Linda A. Carruthers P.L.S. 7053

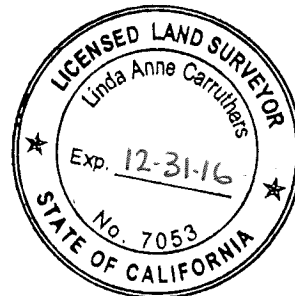

**COUNTY SURVEYOR'S STATEMENT**

This Corner Record was received July 20, 2016 and examined and filed November 21, 2016.

Signed R. S. Smith Title County Surveyor

County Surveyor's Comments tie-outs for Monument restoration only; no boundary or R.O.W. Survey performed.

**DETAIL A 1"=10'**



TIE TO PK/WASHER  
STAMPED PLS 7053  
IN SIDEWALK

NOTE: RIGHT OF WAY LINES  
ARE NOT PARALLEL

TIE TO PK/WASHER  
STAMPED PLS 7053  
IN SIDEWALK

**MAIN STREET**

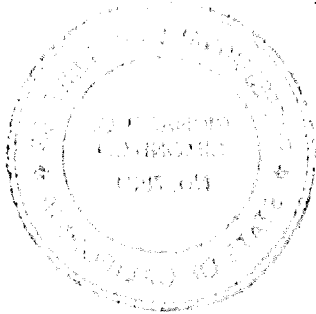

S70°59'45"W  
41.19'

N87°16'30"W  
239.24'

N46°39'58"W  
46.18'

⊙ M262

TIE TO PK/WASHER  
STAMPED PLS 7053  
IN SIDEWALK

S07°54'02"E  
9.16'

SET PK  
NEW MONUMENT  
LOCATION

N07°39'11"W  
32.22'

TIE TO NAIL/TAG  
STAMPED LS 4694  
IN SIDEWALK

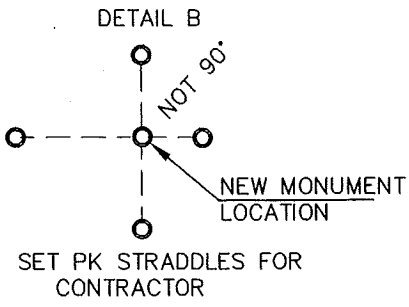

- ⊙ FD 2" BRASS DISK WITH TAG AND TACK LS 2897 STAMPED M 262 IN WELL MONUMENT PER 19 RM 83
- ⊕ SET 1" BRASS DISK PLS 7053

<b>MONUMENT RELOCATION 4TH &amp; MAIN STREET DETAIL A</b>	
<b>LINDA A. CARRUTHERS &amp; ASSOCIATES P.O. BOX 2053 SAUSALITO, CA 94966</b>	
SCALE 1"=10'	DATE APRIL 2016
JOB NO. 16-954CR	SHEET 1 OF 1