

**CORNER RECORD**

Document Number 065-112-52

City of Sausalito

County of Marin, California

Brief Legal Description Lands of Dreyer, 21 RS 90.

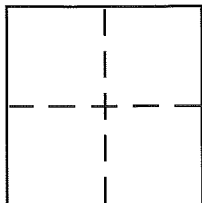

**CORNER TYPE**

Government Corner  Control   
Meander  Property   
Rancho  Other   
Date of Survey 1/18/16

**COORDINATES (Optional)**

N. \_\_\_\_\_  
E. \_\_\_\_\_  
Zone \_\_\_\_\_ NAD27  NAD83   
NAD83 Epoch \_\_\_\_\_  
Elev. \_\_\_\_\_  
Vert. Datum: NGVD29  NAVD88   
Meas. Units: Metric  Imperial

Corner - Left as found  Found and tagged  Established  Reestablished  Rebuilt

Identification and type of corner found: Evidence used to identify or procedure used to establish or reestablish the corner:

Found monuments as shown on Plat.

A description of the physical condition of the monument as found and as set or reset:

Set monuments as shown on Plat.

**SURVEYOR'S STATEMENT**

This Corner Record was prepared by me or under my direction in conformance with the Land Surveyor's Act on March 22, 2014

Signed \_\_\_\_\_ ~~PLS~~ or R.C.E. No. 21998

**COUNTY SURVEYOR'S STATEMENT**

This Corner Record was received MARCH 28, 2016

and examined and filed MAY 18, 2016

Signed Richard G. Simonitch P.L.S or R.C.E. No. 7821

Title County Surveyor

County Surveyor's Comment \_\_\_\_\_

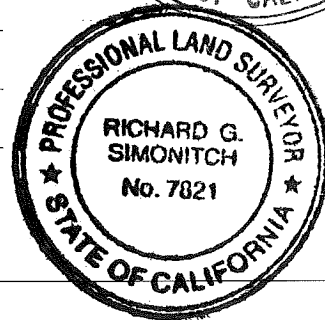
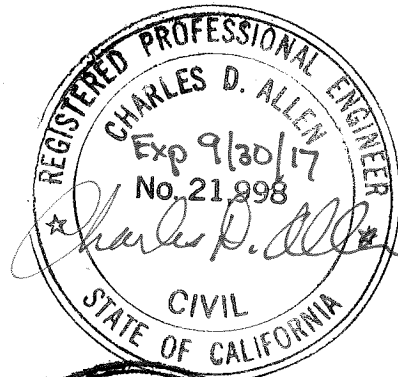

**LEGEND**

- PROPERTY BOUNDARY LINE.
- TIE LINE.
- MONUMENT LINE.
- FOUND CITY MONUMENT.
- FOUND 1/2" REBAR, NO CAP, PER R1.
- FOUND 3/4" IRON PIPE WITH PLASTIC PLUG LS 4694, PER R2 .
- SET 5/8" REBAR & PLASTIC CAP, RCE 24059.
- ⊗ SET BRASS NAIL & TAG, RCE 24059, ON CONCRETE CURB.
- S.F.N.F. SEARCHED FOR NOT FOUND.

**NOTE**

ALL DISTANCES ARE IN FEET AND DECIMALS THEREOF.

**REFERENCES**

- R1 21 RS 90, SEPT. 30, 1986
- R2 2011 RS 171, DEC. 15, 2011.

2011 RS 171

