

CLOUDVIEW TRAIL

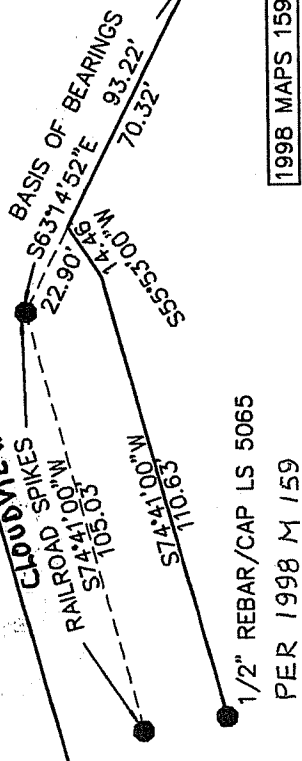

1998 MAPS 159

BASIS OF BEARINGS; S63°14'52"E BETWEEN FOUND RAILROAD SPIKE AND FOUND NAIL/WASHER IN CONCRETE CYLINDER PER 1998 M 159.

NAIL/WASHER IN CONCRETE CYLINDER.

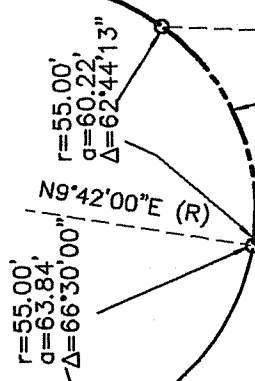

SET 'PK' NAIL/WASHER
 STAMPED LS 5767

NOTES:

- DIMENSIONS ARE IN FEET AND DECIMALS THEREOF
- = FOUND MONUMENTATION PER 1998 MAPS 159, AS NOTED
- = SET 1/2" REBAR/CAP LS 5767 UNLESS OTHERWISE NOTED

ALL OTHER EASEMENTS NOT SHOWN HEREON

CORNER RECORD
 156 CLOUDVIEW TRAIL
 SAUSALITO MARIN COUNTY
 M. BROGAN AND ASSOCIATES, INC.
 100 LABREA WAY
 SAN RAFAEL CA 94903
 JOB NO. 5622 NOT TO SCALE

APN 64-275-36

