

CORNER RECORD

City of Sausalito
County of Marin, California

Document Number: APN 064-232-18, 05

Brief Legal Description: 5' PUE between Lot 13 & 14 as shown on the map entitled "Record of Survey of Resubdivision of a portion of Toyon Terraces", recorded in Book 2 Official Surveys Page 173A, Marin County Records.

CORNER TYPE

Government Corner
Meander
Rancho
Date of Survey: FEB. 2015

Control
Property
Other

COORDINATES

(Optional)

N. _____
E. _____
Zone _____ Datum _____
Elev. _____

Corner --Left as found Found and tagged Established Reestablished Rebuilt

Identification and type of corner found: Evidence used to identify or procedure used to establish or reestablish the corner.

This survey is based on found monuments as shown on "Record of Survey of Resubdivision of a portion of Toyon Terraces", recorded in Book 2 Official Surveys Page 173A, Marin County Records, and Corner Record APN 064-232-21, field 9/24/2014

A Description of the physical condition of the monument as found and as set or reset

See Sheet two.

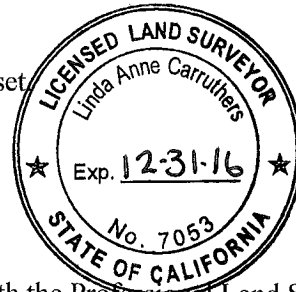

SURVEYOR'S STATEMENT

This Corner Record was prepared by me or under my direction in conformance with the Professional Land Surveyor's Act on May 10, 2016

Signed Linda Carruthers P.L.S. 7053

COUNTY SURVEYOR'S STATEMENT

This Corner Record was received MAY 17, 2016 and examined and filed AUGUST 26, 2016.

Signed Richard G. Simonitch Title County Surveyor



County Surveyor's Comments _____

(R/W VARIES)
TOYON LANE

THE BASIS IF BEARINGS IS BETWEEN M216 RESET AND M217
PER 2 OS 173A & CR APN 064-232-21

M217 \swarrow $N58^{\circ}37'00''W$
360.39

BASIS OF BEARING

M216 RESET
THE PURPOSE OF THIS SURVEY IS FOR SEWER LINE
REPLACEMENT

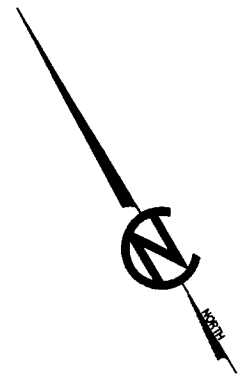

$S31^{\circ}23'00''W$
20.00'

$\Delta=52^{\circ}51'00''$
 $L=73.79R=80.00$

LOT 11B

110.02' T

2 OS 173A
LOT 13

$N05^{\circ}46'00''W$
60.87' T

$R=80.00'$
 $L=2.51'$
 $\Delta=1^{\circ}47'41''$

$S55^{\circ}49'50''W$

2.50'

85.99'

5.00'

$S37^{\circ}53'30''E$

80.08' T

3.06'

$N 87^{\circ}13'20'' E$
 $S 14^{\circ}30'00'' E$

5' PUE 2 OS 173A

LOT 14

LOT 12

LOT 15

LEGEND

- \odot FD WELL MONUMENT 2 OS 173A
- \oplus FD NAIL & BRASS WASHER PLS 7053
PER CR. RECORD 064-232-21
- \circ SET 5/8" RB/CAP PLS 7053
- T TOTAL

**CORNER RECORD
SURVEY OF 5' PUE
BETWEEN LOT 13 & 14 2 OS 173A**

**LINDA A. CARRUTHERS & ASSOCIATES
PO BOX 2053
SAUSALITO, CA 94966**

SCALE: 1"=20'

DATE: MAY 2016

JOB NO. 14-887

SHEET 2 OF 2