

CORNER RECORD

Document Number APN 064-104-01

County of Marin, California

City of Sausalito

Brief Legal Description: Lots 1 and 2, block 85 "Sausalito Land & Ferry Company" filed in Rack one of Maps Pull 9, Marin County Records.

CORNER TYPE

COORDINATES

Government Corner
Meander
Rancho
Date of Survey October 2003

Control
Property
Other

(Optional)

N. _____
E. _____
Zone _____ Datum _____
Elev. _____

Corner --Left as found Found and tagged Established Reestablished Rebuilt

Identification and type of corner found: Evidence used to identify or procedure used to establish or reestablish the corner.

This survey is based upon found monuments shown on that certain Parcel Map entitled, "Lands of Brown and Wang" recorded in Book 15 of Parcel Maps at Page 18, Marin County Records.

A Description of the physical condition of the monument as found and as set or reset.

See Sheet two.

SURVEYOR'S STATEMENT

This Corner Record was prepared by me or under my direction in conformance with the Professional Land Surveyor's Act on 5-16 2005

Signed Linda Anne Carruthers B.L.S. 7053



COUNTY SURVEYOR'S STATEMENT

This Corner Record was received MAY 18, 2005 and examined and filed MAY 18, 2005.

Signed [Signature] Title COUNTY SURVEYOR

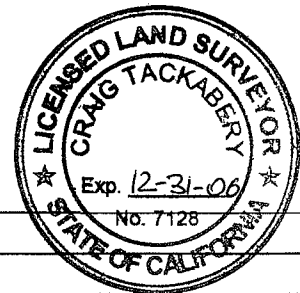



County Surveyor's Comments _____

BOUNDARY SURVEY
LANDS OF ROTARY HOUSING CORP.
D.N. 2002-56868

LINDA A. CARRUTHERS & ASSOCIATES
2015 BRIDGEWAY, STE. 301D
SAUSALITO, CA 94965

SCALE 1"=40'
JOB NO. 99-291 DATE MAY 2005

LEGEND

-  FD CITY OF SAUSALITO WELL MONUMENT
-  SET 5/8" REBAR & CAP PLS 7053

BASIS OF BEARINGS
S 51°35'01" W 270.03
(15 PM 18)



M185

M186

N 38°24'59" W
20.80'

BUTTE STREET

S 51°35'01" W 100.00'

60.00'
N 51°35'01" E

N 38°24'59" W

240.00'

S 38°24'59" E

240.00'

1
APN 064-104-01
BLOCK 85
RACK 1 PULL 9

2

N 51°35'01" E 100.00'

N 38°24'59" W
60.00'

COLOMA STREET

N 38°24'59" W
60.00'

N 51°35'01" E 100.00'

OLIMA STREET

SACRAMENTO AVENUE