

CORNER RECORD

City of TIBURON

Document Number 59-201-42 (APN)

County of MARIN, California

Brief Legal Description: DOC. NO. 93-072390 / PORTION LOT 22, MAP #3 OF LYFORD'S HYGEIA

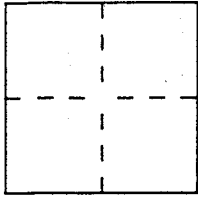

CORNER TYPE

Government Corner Control
Meander Property
Rancho Other
Date of Survey OCT. 19, 1996

**COORDINATES
(Optional)**

N. _____
E. _____
Zone _____ Datum _____
Elev. _____

Corner — Left as found Found and tagged Established Reestablished Rebuilt

Identification and type of corner found: Evidence used to identify or procedure used to establish or reestablish the corner:

FOUND EXISTING 2x2 HUB (CONDITION DETERIORATING)
SHOWN PER DETAIL 3 AT THE SOUTHEAST CORNER
OF GERHMANN PARCEL AS DEPICTED UPON THE RECORD
OF SURVEY ENTITLED "RECORD OF SURVEY, LAND OF GERHMANN"
FILED IN BOOK 32 OF OFFICIAL SURVEYS, AT PAGE 92

A description of the physical condition of the monument as found and as set or reset:

SET 1/2" REBAR WITH PLS CAP 5379 AFFIXED TO TOP
AT OLD HUB LOCATION; (DID NOT REMOVE HUB); THE 1/2" REBAR
WAS DRIVEN THROUGH THE EXISTING HUB REMAINS

SURVEYOR'S STATEMENT

This Corner Record was prepared by me or under my direction in conformance with the Land Surveyors' Act on Oct 24th 1996.

Signed [Signature] L.S. or R.C.E. Number PLS 5379
RENEWAL 6-30-96

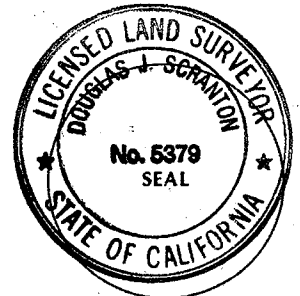

COUNTY SURVEYOR'S STATEMENT

This Corner Record was received November 12 1996 and examined and filed 11-12 1996.

Signed [Signature] Title DCS

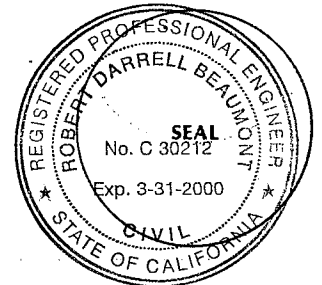

County Surveyor's Comment _____

JN: 9832

PREPARED BY: DJ SCRANTON SURVEYING NOVATO, CA