

CORNER RECORD

Document Number A:P.N. 59-071-61

City of TIBURON

County of MARIN, California

Brief Legal Description PTN. PCL. 3 + PTN. PCL. 2, S PM 92; D.N. 94-031492 (BOTH MARIN CO. RECORDS)

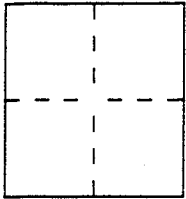

CORNER TYPE

Government Corner Control
Meander Property
Rancho Other
Date of Survey JAN. 1996 + MAY 1997

COORDINATES (Optional)

N. _____
E. _____
Zone _____ Datum _____
Elev. _____

Corner — Left as found Found and tagged Established Reestablished Rebuilt

Identification and type of corner found: Evidence used to identify or procedure used to establish or reestablish the corner:
FOUND 1/2" REBAR & CAP LS 3887 AND FOUND NAIL, NO TAG, AS SHOWN ON 32 OS 50 (PTS A+B), MARIN CO. RECORDS. HELD FOR BASIS OF BEARINGS N 31°59'00"W. FOUND NAIL & TAG LS 2897 AND FOUND 3/4" IP W/ ILLEGIBLE TAG PRESUMED ORIGINALS MONUMENTS FROM S PM 92.

A description of the physical condition of the monument as found and as set or reset: MONUMENTS SET ARE 3/4" IRON PIPE W/ PLASTIC CAP "RCE 18221." RESET NAIL (PT B ABOVE) W/ IRON PIPE AND RE-ESTABLISHED 3 CORNERS W/ IRON PIPES, ALL AS SHOWN ON PAGE 2 OF 2, THIS CORNER RECORD.

SURVEYOR'S STATEMENT

This Corner Record was prepared by me or under my direction in conformance with the Land Surveyors' Act on MAY 21 1997.

Signed Bruce A. Gowdy L.S. or R.C.E. Number LS 6725

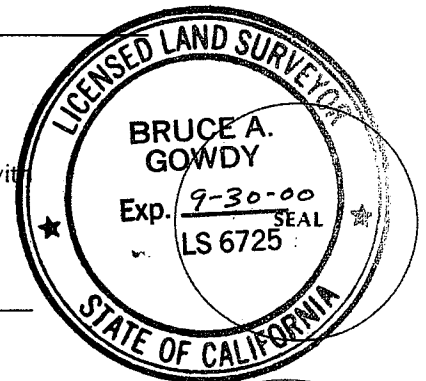

COUNTY SURVEYOR'S STATEMENT

This Corner Record was received MAY 27 1997 and examined and filed MAY 28 1997.

Signed John M. Wooley Title Deputy

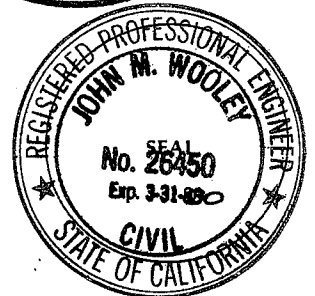

County Surveyor's Comment _____

