

**CORNER RECORD**

Document Number ARN.058-281-06

City of TIBURON

County of MARIN, California

Brief Legal Description LOT 91, "MARINERO RESIDENCE NO. 1, UNIT 2", TIBURON FILED IN 11 RM 72, M.C.R.

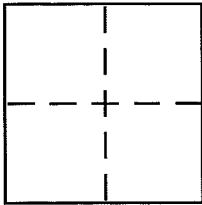

**CORNER TYPE**

Government Corner  Control   
Meander  Property   
Rancho  Other   
Date of Survey 2/9/04

**COORDINATES (Optional)**

N. \_\_\_\_\_  
E. \_\_\_\_\_  
Zone \_\_\_\_\_ NAD27  NAD83   
NAD83 Epoch \_\_\_\_\_  
Elev. \_\_\_\_\_  
Vert. Datum: NGVD29  NAVD88   
Meas. Units: Metric  Imperial

Corner - Left as found  Found and tagged  Established  Reestablished  Rebuilt

Identification and type of corner found: Evidence used to identify or procedure used to establish or reestablish the corner:  
FOUND STANDARD WELL MONUMENTS PER 11 RM 72. FOUND IRON PINS PER CORNER RECORD "APN. 58-281-06" AND 11 RM 72 RECORD INFORMATION BASED ON FIELD SURVEY. SET POINTS AS INDICATED HEREON.

A description of the physical condition of the monument as found and as set or reset:  
FOUND MDNUMENTS APPEAR UNDISTURBED. SET AS INDICATED HEREON.

**SURVEYOR'S STATEMENT**

This Corner Record was prepared by me or under my direction in conformance with the Land Surveyor's Act on FEB. 9 2004  
Signed [Signature] P.L.S or R.C.E. No. PLS 6234



**COUNTY SURVEYOR'S STATEMENT**

This Corner Record was received FEBRUARY 23, 2004  
and examined and filed MARCH 15, 2004  
Signed [Signature] P.L.S or R.C.E. No. 7128  
Title COUNTY SURVEYOR

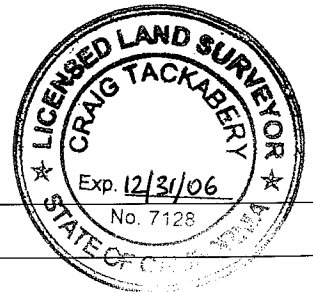

County Surveyor's Comment \_\_\_\_\_