

CORNER RECORD

Document Number APN:058-271-18

City of TIBURON and County of MARIN, California

Brief Legal Description: LOT 75, PER PARCEL MAP FILED 2/6/1973 IN BOOK 7 OF PARCEL MAPS AT PAGE 143, MARIN COUNTY OFFICIAL RECORDS.

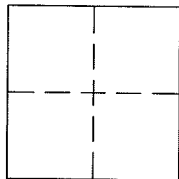

CORNER TYPE

Government Corner [] Control []
Meander [] Property []
Rancho [] Other []

Date of Survey 3/14/2017

COORDINATES (Optional)

N: _____
E: _____
Zone: _____ NAD 27 [] NAD 83 []
Elev: _____
Vert. Datum: NGVD29 [] NAVD88 []
Meas. Units: Metric [] Imperial

CORNER -- LEFT AS FOUND FOUND AND TAGGED ESTABLISHED REESTABLISHED REBUILT

Identification and type of corner found: Evidence used to identify or procedure used to establish or reestablish the corner:

FOUND MONUMENTS PER R1 AND R2 AS SHOWN ON PAGE 2.

A description of the physical condition of the monument as found and as set or reset:

FOUND MONUMENTS AND SET MARKERS AS SHOWN ON PAGE 2.

SURVEYOR'S STATEMENT:

The corner record was prepared by me or under my direction in conformance with

the Land Surveyors' Act on MARCH 17, 2017

Signed: [Signature] L.S.# 9361



COUNTY SURVEYOR'S STATEMENT:

The corner record was received April 5, 2017

and examined and filed MAY 02, 2017

Signed: [Signature] R.C.E. or L.S. No. 9292

Title: DEPUTY C.S.

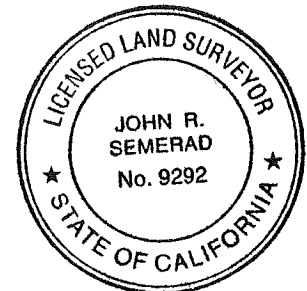

COUNTY SURVEYOR'S COMMENT:

LEGEND

- PROPERTY BOUNDARY LINES PER R1,R2
- MONUMENT LINE PER R1,R2
- TIE LINE
- ⊙ FOUND 1/8" PIN IN CONC. CYLINDER PER R1,R2
- FOUND 3/4" IRON PIPE & BRASS TAG RCE 12510 PER R2
- SET #5 REBAR & PLASTIC CAP LS 9361
- R1 RECORD MAP: BOOK 11, PAGE 72
- R2 PARCEL MAP: BOOK 7, PAGE 143
- IP IRON PIPE
- C CALCULATED
- M MEASURED

AMERICAN LAND SURVEYING, INC.
 316 Tennessee Avenue, Mill Valley, Ca 94941
 P:(415) 888-8580 ALS17009 E:office@alspls.com

CORNER RECORD

