

**CORNER RECORD**

Document Number \_\_\_\_\_

City of Tiburon

County of Marin, California

Brief Legal Description Being Lot 28, Map of Mt. Tiburon Unit 2 (11 RM 57)

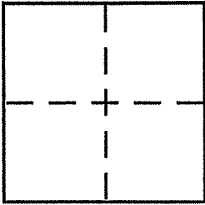

**CORNER TYPE**

Government Corner  Control   
Meander  Property   
Rancho  Other   
Date of Survey Nov. 14, 2006

**COORDINATES (Optional)**

N. \_\_\_\_\_  
E. \_\_\_\_\_  
Zone \_\_\_\_\_ NAD27  NAD83   
NAD83 Epoch \_\_\_\_\_  
Elev. \_\_\_\_\_  
Vert. Datum: NGVD29  NAVD88   
Meas. Units: Metric  Imperial

Corner - Left as found  Found and tagged  Established  Reestablished  Rebuilt

Identification and type of corner found: Evidence used to identify or procedure used to establish or reestablish the corner:

Found Standard Well Monuments per Map of Mt. Tiburon Unit 2, See Page 2

A description of the physical condition of the monument as found and as set or reset: Set Points as Shown on Page 2.

**SURVEYOR'S STATEMENT**

This Corner Record was prepared by me or under my direction in conformance with the Land Surveyor's Act of November 21, 2006

Signed William E. Schroeder P.L.S. or R.C.E. No. 5814

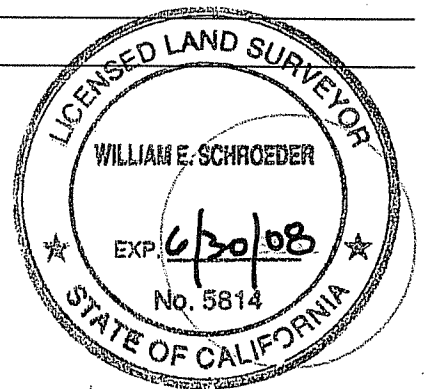

**COUNTY SURVEYOR'S STATEMENT**

This Corner Record was received 12-8-2006

and examined and filed JANUARY 10, 2007

Signed Craig Tackabery P.L.S. or R.C.E. No. 7128

Title COUNTY SURVEYOR



County Surveyor's Comment \_\_\_\_\_