

CORNER RECORD

Document Number 058-252-09

City of Tiburon

County of MARIN, California

Brief Legal Description Lot 15 of 11 R.M. 37, APN 058-252-09

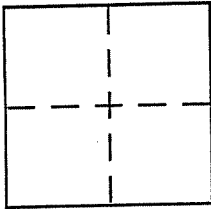

CORNER TYPE

Government Corner Control
Meander Property
Rancho Other
Date of Survey _____

COORDINATES (Optional)

N. _____
E. _____
Zone _____ NAD27 NAD83
NAD83 Epoch _____
Elev. _____
Vert. Datum: NGVD29 NAVD88
Meas. Units: Metric Imperial

Corner - Left as found Found and tagged Established Reestablished Rebuilt

Identification and type of corner found: Evidence used to identify or procedure used to establish or reestablish the corner:
See Back

A description of the physical condition of the monument as found and as set or reset:
See Back

SURVEYOR'S STATEMENT

This Corner Record was prepared by me or under my direction in conformance with the Land Surveyor's Act on December 02, 2008

Signed Michael A. Brogan P.L.S or R.C.E. No. LS 5767

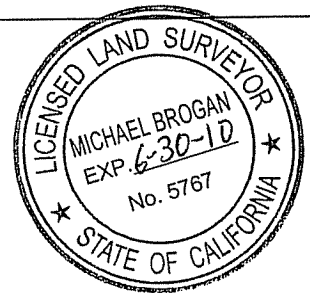

COUNTY SURVEYOR'S STATEMENT

This Corner Record was received December 03, 2008

and examined and filed DECEMBER 30, 2008

Signed _____ P.L.S or R.C.E. No. 7128

Title COUNTY SURVEYOR



County Surveyor's Comment _____

- DIMENSIONS ARE IN FEET AND DECIMALS THEREOF
- ⊕ = FOUND SUBDIVISION MONUMENT
 - = SET 1/2" REBAR/CAP LS 5767 UNLESS OTHERWISE NOTED

APN 58-252-09
 LOT 15
 11 R.M. 37

LOT 24 11 RM 57



SET LEAD PLUG IN ROCK
 WITH BRASS NAIL
 TAGGED LS 5767

SET LARGE NAIL/WASHER
 STAMPED LS 5767
 IN CROTCH OF TREE

