

REFERENCE
 [A] MAP OF ROLLING HILLS,
 FILED FOR RECORD JUNE 1,
 1954 IN VOLUME 8 OF MAPS,
 AT PAGE 11, MARIN COUNTY
 RECORDS.

REFERENCE

- ✱ FOUND MONUMENT PER [A]
- FOUND REBAR & CAP, PLS 6784, PER 2006 MAPS 167.
- SET REBAR & CAP, PLS 6784

NOTE
 RECORD=MEASURED

CORNER RECORD

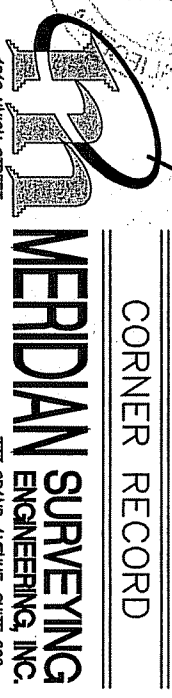

MERRIDIAN SURVEYING, INC.
 1812 UNION STREET
 SAN FRANCISCO, CA 94123
 (415) 440-4131
 info@meridiansurvey.com
 07117
 777 GRAND AVENUE, SUITE 202
 SAN RAFAEL, CA 94901
 (415) 456-5450

