

# CORNER RECORD

City of Tiburon

Document Number APN 055-171-23

County of Marin, California

Brief Legal Description: Parcel 1 "Parcel Map of Assessor's Parcel 55-171-01, Tiburon, California", recorded December 29, 1967, in Book 2 of Parcel Maps at Page 49, Marin County Records.

## CORNER TYPE

Government Corner ☐  
Meander ☐  
Rancho ☐  
Date of Survey: Oct. 2012

Control ☐  
Property ☐  
Other ☐

## COORDINATES

(Optional)

N. \_\_\_\_\_  
E. \_\_\_\_\_  
Zone \_\_\_\_\_ Datum \_\_\_\_\_  
Elev. \_\_\_\_\_

Corner --Left as found ☐ Found and tagged ☐ Established ☐ Reestablished ☐ Rebuilt ☐

Identification and type of corner found: Evidence used to identify or procedure used to establish or reestablish the corner.

This survey is based upon found monuments shown on that certain Record of Survey recorded September 7, 2012, in Book 2012 Maps 102.

A Description of the physical condition of the monument as found and as set or reset.

See Sheet two.

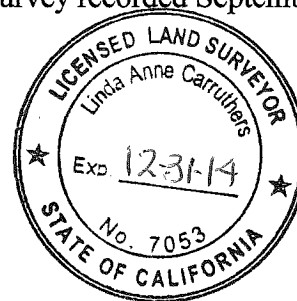

## SURVEYOR'S STATEMENT

This Corner Record was prepared by me or under my direction in conformance with the Professional Land Surveyor's Act on August 21, 2014

Signed Linda A. Carruthers P.L.S. 7053

## COUNTY SURVEYOR'S STATEMENT

This Corner Record was received 08/27, 2014 and examined and filed 9-24-2014, 2014.

Signed Richard G. Simonitch Title DEPUTY



County Surveyor's Comments \_\_\_\_\_

FD PIN IN STD  
WELL MON. R1

FD PIN IN STD  
WELL MON. R1

FD PIN IN STD  
WELL MON. R1

84.98' (85.02' R1)

544'26'00"E

544'26'00"E

2 PM 28

1 PM 49

PINE TERRACE

FD PIN IN STD  
WELL MON. R1

355.82' R1

11 RM 28

2

2 PM 49

APN 055-171-22

APN 055-171-23

1

2012 M 102

MC CART CT

N35°09'25"E

242.42 R1

1 PM 2

TIBURON BLVD.

(60' R/W)

S53°12'32"E

FD CONCRETE HWY  
MONUMENT PER R1  
GOOD CONDITION (HELD)

66.71' R1

S41°23'39"W

CORNER RECORD  
1 MC CART CT., TUBURON, CA  
APN 055-171.23

LINDA A. CARRUTHERS & ASSOCIATES  
2015 BRIDGEWAY, STE. 301D  
SAUSALITO, CA 94965

SCALE: 1"=60'  
DATE: 8/15/14  
JOB NO. 12-797  
SHEET 2 OF 2

R1 RECORD OF SURVEY 2012 M 102



APN 055-171-15

SET 5/8" RB/CAP  
PLS 7053

R=116.00 R1  
Δ=4°12'35" L=82.0