

CORNER RECORD

Document Number APN 51-131-45

City of Mill Valley County of MARIN, California

Brief Legal Description 213 CALIFORNIA AVE, APN 51-131-45
LOTS 36 & 37 BLOCK 201 4 RM 44

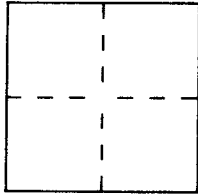

CORNER TYPE

- Government Corner
- Meander
- Rancho
- Date of Survey _____
- Control
- Property
- Other

COORDINATES (Optional)

N. _____
 E. _____
 Zone _____ Datum _____
 Elev. _____

Corner — Left as found Found and tagged Established Reestablished Rebuilt

Identification and type of corner found: Evidence used to identify or procedure used to establish or reestablish the corner:

See Sketch on back

31 OS 53 → Basis of survey

A description of the physical condition of the monument as found and as set or reset: _____

See Sketch on back

SURVEYOR'S STATEMENT

This Corner Record was prepared by me or under my direction in conformance with the Land Surveyors' Act on July 22 19 99.

Signed Michael A. Brogan L.S. or R.C.E. Number 5767

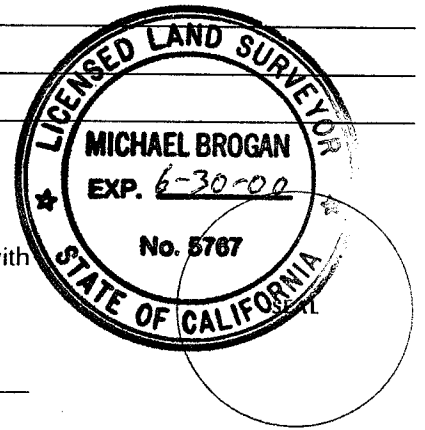

COUNTY SURVEYOR'S STATEMENT

This Corner Record was received JULY 26 19 99 and examined

and filed JULY 27 19 99.

Signed John M. Wooley Title DEPUTY

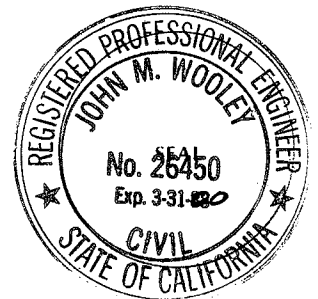

County Surveyor's Comment: _____

