

CORNER RECORD

Document Number 050-253-07
County of MARIN, California

City of Vicinity Mill Valley

Brief Legal Description Control Monument: 2005 MAPS 225

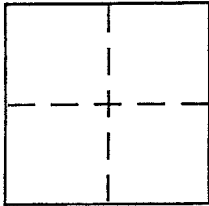

CORNER TYPE

Government Corner Control
Meander Property
Rancho Other
Date of Survey 7-27-15

COORDINATES (Optional)

N. _____
E. _____
Zone _____ NAD27 NAD83
NAD83 Epoch _____
Elev. _____
Vert. Datum: NGVD29 NAVD88
Meas. Units: Metric Imperial

Corner - Left as found Found and tagged Established Reestablished Rebuilt

Identification and type of corner found: Evidence used to identify or procedure used to establish or reestablish the corner:

Replaced lost Railroad Spike @ Laurel Way / Jean St
in Tam Valley, referenced prior to destruction -

A description of the physical condition of the monument as found and as set or reset:

Rebuilt as County Monument

SURVEYOR'S STATEMENT

This Corner Record was prepared by me or under my direction in conformance with the Land Surveyor's Act on July 27 2015

Signed Michael C. Brogan P.L.S or R.C.E. No. LS 5767

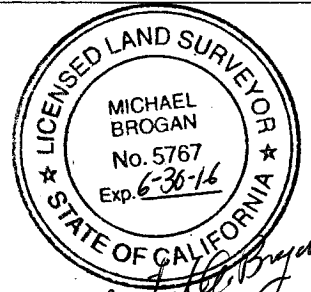

Michael C. Brogan

COUNTY SURVEYOR'S STATEMENT

This Corner Record was received August 4, 2015

and examined and filed NOVEMBER 25, 2015

Signed [Signature] P.L.S or R.C.E. No. 7821

Title County Surveyor

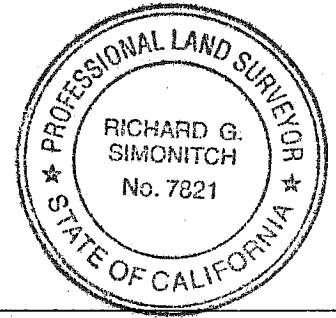

County Surveyor's Comment _____

SHORELINE

2005 RS 225

HIGHWAY

FOUND TAG "LS 3226"
N77° 49' W 0.06' OF
CORNER

S77° 49' E
30.00

N01° 14' 34.87" E 158.39
BASIS OF BEARING

FOUND TAG
LAUREL ST "LS 3226"
RAILROAD SPIKE

JEAN

25

SET MAG NAIL
REFERENCE POINT

A.P.N
050-252-21

S77° 49' 00" E
30.00

N16° 18' 50" W
155.51

WAY

N28° 00' 00" E
122.14

N12° 11' 00" E
19.53

S42° 32' 33" W
55.83

A.P.N
050-253-07

9

SET MAG NAIL
REFERENCE POINT

19

DETAIL - FOUND RAILROAD SPIKE
RESET WITH COUNTY
STANDARD MONUMENT

18 A.P.N
050-252-08

JEAN STREET

17

LAUREL

S27° 40' 30" W
181.60

60' R.O.W

6

A.P.N
050-254-05

5

SET MAG NAIL
REFERENCE POINT



COUNTY OF MARIN

DEPARTMENT OF PUBLIC WORKS
SURVEY SECTION

SCALE: 1" = 40'

CORNER RECORD