

CORNER RECORD

Document Number AP# 50-071-04

City of MILL VALLEY

County of MARIN, California

Brief Legal Description PARCEL A AS SHOWN ON THE PARCEL MAP FILED APRIL 9, 1975, IN BOOK 11 OF PARCEL MAPS AT PAGE 38, IN THE OFFICE OF THE RECORDER OF THE COUNTY OF MARIN.

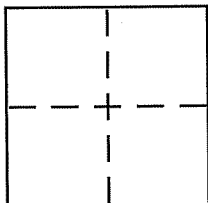

CORNER TYPE

Government Corner Control
Meander Property
Rancho Other
Date of Survey JUNE 2005

COORDINATES (Optional)

N. _____
E. _____
Zone _____ NAD27 NAD83
NAD83 Epoch _____
Elev. _____
Vert. Datum: NGVD29 NAVD88
Meas. Units: Metric Imperial

Corner - Left as found Found and tagged Established Reestablished Rebuilt

Identification and type of corner found: Evidence used to identify or procedure used to establish or reestablish the corner:

● = FOUND 1/2" REBAR WITH PLASTIC CAP INSCRIBED "RCE 11181"

A description of the physical condition of the monument as found and as set or reset:

○ = SET 5/8" REBAR WITH PLASTIC CAP INSCRIBED "LANGFORD LS 6895"

SURVEYOR'S STATEMENT

This Corner Record was prepared by me or under my direction in conformance with the Land Surveyor's Act on AUGUST 28, 2007

Signed Richard L. Langford P.L.S or R.C.E. No. PLS 6895

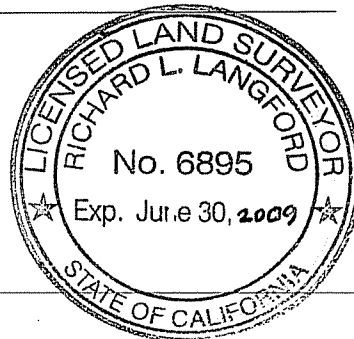

COUNTY SURVEYOR'S STATEMENT

This Corner Record was received SEPTEMBER 10, 2007

and examined and filed OCTOBER 2, 2007

Signed [Signature] P.L.S or R.C.E. No. 7128

Title COUNTY SURVEYOR



County Surveyor's Comment _____