

CORNER RECORD

Document Number A.P. # 50-061-55

City of Vicinity Mill Valley

County of MARKIN, California

Brief Legal Description Parcel 3, 10 P.M. 59 // # 529 Pine Crest Road // APN 50-061-55

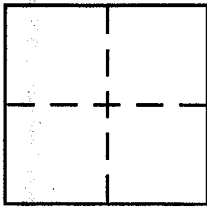

CORNER TYPE

- Government Corner Control
- Meander Property
- Rancho Other
- Date of Survey _____

COORDINATES (Optional)

N. _____
 E. _____
 Zone _____ NAD27 NAD83
 NAD83 Epoch _____
 Elev. _____
 Vert. Datum: NGVD29 NAVD88
 Meas. Units: Metric Imperial

Corner - Left as found Found and tagged Established Reestablished Rebuilt

Identification and type of corner found: Evidence used to identify or procedure used to establish or reestablish the corner:
See Back

A description of the physical condition of the monument as found and as set or reset:
See Back

SURVEYOR'S STATEMENT

This Corner Record was prepared by me or under my direction in conformance with
 the Land Surveyor's Act on September 18 2003
 Signed Michael A. Brogan P.L.S or R.C.E. No. LS 5767

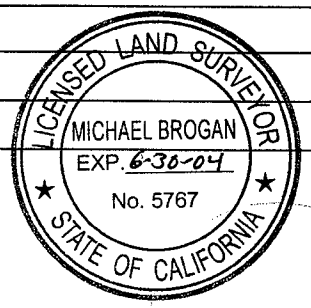

COUNTY SURVEYOR'S STATEMENT

This Corner Record was received SEPTEMBER 19, 2003
 and examined and filed SEPTEMBER 29, 2003
 Signed C P.L.S or R.C.E. No. 7128
 Title COUNTY SURVEYOR



County Surveyor's Comment _____