

CORNER RECORD

PRE-CONSTRUCTION

Agency Index

DPW# 19-080

Document Number

APN 047-221-18 ADJ

City of Mill Valley (APN 047-221-18) County of Marin, California

Brief Legal Description MONUMENT WELL LOCATED WITHIN THE INTERSECTION OF LAVERNE AVENUE AND MELROSE AVENUE

CORNER TYPE

COORDINATES (Optional)

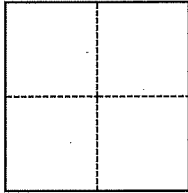

- Government Corner
- Meander
- Rancho
- Control
- Property
- Other

Date of Survey June 5, 2019

N. _____ E. _____
 Elevation _____
 Units Metric U.S. Survey Foot
 Horizontal Datum _____
 Zone _____ Epoch Date _____
 Vertical Datum _____
 Complies with Public Resources Code §§8801-8819
 Complies with Public Resources Code §§8890-8902

PLS Act Ref.: 8765(d) 8771 8773 Other:
 Corner/Monument: Left as found Established Rebuilt Pre-Construction
 Found and tagged Reestablished Referenced Post-Construction

Narrative of corner identified and monument as found, set, reset, replaced, or removed:
 See sheet #2 for description(s):

FOUND 2" BRASS DISK WITH PUNCH IN MONUMENT WELL LOCATED WITHIN THE INTERSECTION OF LAVERNE AVENUE AND MELROSE AVENUE AS SHOWN ON RECORD OF SURVEY OF LANDS OF D'AMICO FILED DECEMBER 27, 2005 IN BOOK 2005 OF MAPS ON PAGE 367 OF OFFICIAL RECORDS.
 THIS POINT WAS REFERENCED PRIOR TO A CONSTRUCTION PROJECT IN THE VICINITY.

SURVEYOR'S STATEMENT

This Corner Record was prepared by me or under my direction in conformance with the Professional Land Surveyors' Act on July 15, 2019
 Signed [Signature] (P.L.S.) or R.C.E. No. 8934



COUNTY SURVEYOR'S STATEMENT

This Corner Record was received July 22, 2019
 and examined and filed SEP. 4, 2019
 Signed [Signature] P.L.S. or R.C.E. No. 9292
 Title DEPUTY C.S.



County Surveyor's Comment



NOT TO SCALE

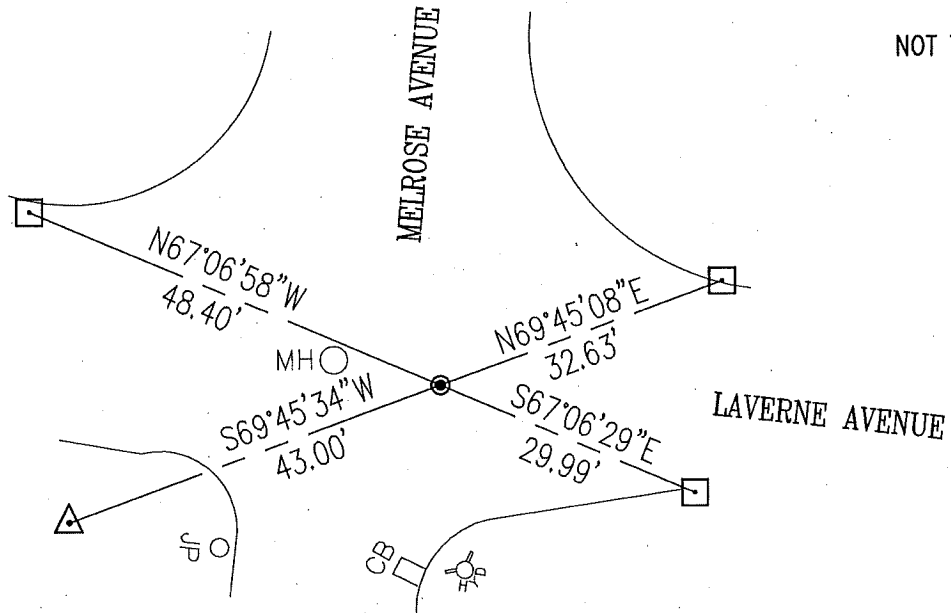

LEGEND

<u>SYMBOLS</u>	<u>DESCRIPTION</u>
	FOUND STANDARD CITY MONUMENT
	SET REBAR AND CAP
	SET MAG NAIL