

L. A. Stevens & Associates, Inc.
Professional Land Surveyors
Novato, California

Lands of Ciauri
Job #: 08-1152

CORNER RECORD

Document Number 043-410-25

City of Mill Valley, County of Marin, California

Brief Legal Description: Being Lot 36 of that certain map entitled "Map of Strawberry Vista Subdivision, a Subdivision of Parcel 3, 10 PM 54, and as described in Doc. No. 93-93779," filed for record January 18, 1995 in Volume 21 of Maps at Page 33, Marin County Records.

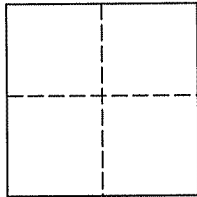

CORNER TYPE

Government Corner Control
Meander Property
Rancho Other
Date of Survey July 2, 2008

COORDINATES (Optional)

N _____
E _____
Zone _____ NAD27 NAD83
NAD 83 Epoch _____
Elev. _____
Vert. Datum: NGVD29 NAVD88
Meas. Units: Metric Imperial

Corner - Left as found Found and tagged Established Reestablished Rebuilt

Identification and type of corner found: Evidence used to identify or procedure used to establish or reestablish the corner:
See Page 2 of 2

A description of the physical condition of the monument as found and as set or reset:
See Page 2 of 2

SURVEYOR'S STATEMENT

This Corner Record was prepared by me or under my direction in conformance with

The Land Surveyor's Act on July 16, 2008.

Signed [Signature] P.L.S 6649



COUNTY SURVEYOR'S STATEMENT

This Corner Record was received JULY 31, 2008

and examined and filed AUGUST 21, 2008

Signed [Signature] P.L.S. of R.C.E. No. 7128

Title COUNTY SURVEYOR

County Surveyors' Comment _____



All distances shown are in feet and decimals thereof

GRAPHIC SCALE

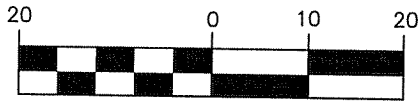

IN FEET

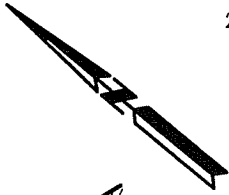

Boundary Line Determined By This Survey

Existing Residence

Lands of Ciauri

(DN 2004-103139)

Lot 36
21 RM 33

Lands of Hugo

(DN 2002-074846)

Lot 37
21 RM 33

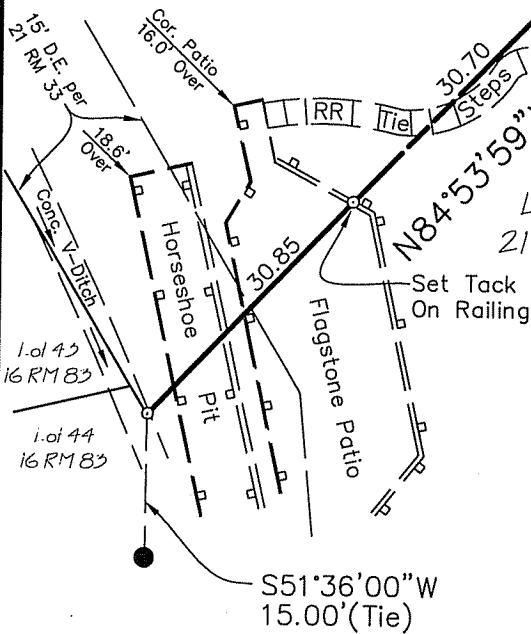

LEGEND

- Found 3/4" Iron Pipe & Plastic Plug, Stamped "RCE 27577" Per 21 RM 33
- ⊙ Found 2" Brass Disc & Punch, Stamped "RCE 27577", In Hand Hole Per 21 RM 33
- Found "X" On V-Ditch, Set Rivet & Tag, Stamped "LS 6649". Unless Noted Otherwise
- ⊙ Set 3/4" Iron Pipe & Plastic Plug, Stamped "LS 6649"
- ≡≡≡ Wood Retaining Wall
- D.E. Drainage Easement
- RR Railroad
- (R) Radial



7-23-08

**Plat of Survey
Lands of Ciauri**

(DN 2004-103139)

Mill Valley Marin County California
Scale: 1" = 20' July 2008

L.A. Stevens & Associates, Inc.

Professional Land Surveyors * (415) 382-7713
7 Commercial Blvd., Suite 1 * Novato, CA 94949

Job # 08-1152

Lawrence A. Stevens, PLS 6649
my license expires 12/31/09