

# CORNER RECORD

Document Number 043-293-58

City of MILL VALLEY County of Marin California.

Brief Legal Description: DN-56892- PARCEL 1 OF 8 P.M. 84; PTN OF LOT 40 9 RM 55

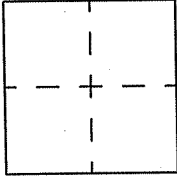

### CORNER TYPE:

Government Corner  Control   
 Meander  Property   
 Rancho  Other   
 Date of Survey \_\_\_\_\_

### COORDINATES

[Optional]  
 N> \_\_\_\_\_  
 E> \_\_\_\_\_  
 Zone \_\_\_\_\_ Datum \_\_\_\_\_  
 Elev> \_\_\_\_\_

CORNER:----- Left as found  Found & Tagged  Established  Reestablished  Rebuilt

Identification & Type of Corner Found: Evidence used to identify or procedure used to establish or reestablish the corner:

FOUND EXISTING MONUMENTS: SHOWN ON REVERSE

A description of the physical condition of the monument as found and as set or reset: SET REBAR & CAP,

RCE# 18200, AT LOCATIONS SHOWN ON REVERSE.

### SURVEYOR'S STATEMENT

The corner record was prepared by me or under my direction in conformance with

the Land Surveyors' Act on DEC 1998

Signed: Douglas J. Matteson LS or RCE #18200



### COUNTY SURVEYORS STATEMENT

This corner record was received: FEB. 8 1999

and filed FEBRUARY 9 1999

Signed: John M. Wooley Title: DEPUTY

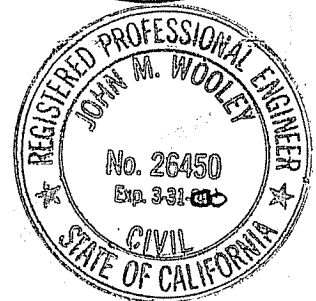

COUNTY SURVEYOR'S COMMENT \_\_\_\_\_

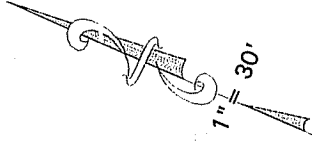

LANDS OF LILICH  
DN 98-56892  
PARCEL ONE  
OF 8 PM 84

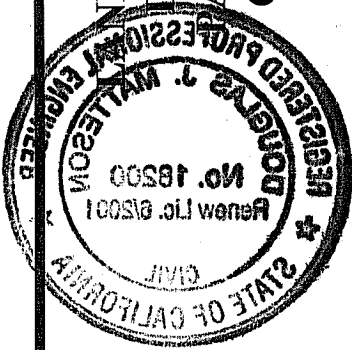

FND PT. L.S. #4394

31.21'  
N 26°20'35" W

FND PT. L.S. #4394

89.29'  
S 78°54'28" E

178.50'

123.17'

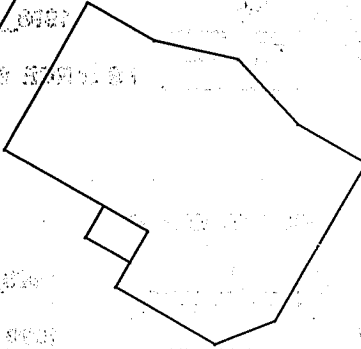

Existing Bulkhead

S.F. BAY WATERS

PCL 1  
8 PM 84

40.00'

51.00'

58.75'

44.80'

S 78°40'52" W

130.80'

49.00'

DOUGLAS J. MATTESON  
CIVIL ENGINEER & LAND  
SURVEYOR

200 GATE 5 RD. #208  
SAUSALITO CA. 94965

332 7614

LEGEND:

⊕ SET 5/8" REBAR & TAG  
RCE 18200

AP N 043-293-58