

CORNER RECORD

Documented Number 039-290-55

City of Tiburon County of Marin, California

Brief Legal Description Lot 26 & a portion of Lot 25, 19 RM 23 & 1999 Maps 224

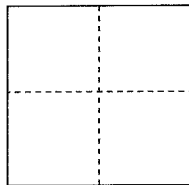

CORNER TYPE

Government Corner Control
Meander Property
Rancho Other

COORDINATES(Optional)

N. _____
E. _____
Zone _____ NAD27 NAD83
NAD83 Epoch _____
Elevation _____
Vert. Datum: NGVD 29 NADV88
Meas. Units: Metric Imperial

Date of Survey June 4, 2014

Corner- Left as found Found and tagged Established Reestablished Rebuilt

Identification and type of corner found: Evidence used to identify or procedure used to establish or reestablish the corner:
Reestablish the most Southwesterly corner of APN 039-290-55 as said parcel is shown upon 1999 Maps 224 done by this office in April 1998. The missing corner was set from standard street monuments on GilMartin Drive shown upon both 1999 Maps 224 and 19 RM 23. Refer to sketch on reverse side for details.

A description of the physical condition of the monument as found and as set or reset:
Set one half inch rebar with a yellow plastic cap attached to the top of the rebar and the top being driven flush to the surrounding grade. The cap is stamped "Scranton, PLS 5379".

SURVEYOR'S STATEMENT

This Corner Record was prepared by me or under my direction in conformance with

the Land Surveyor's Act on June 13, 2014

Signed Douglas J. Scranton P.L.S. or R.C.E. No.: PLS 5379

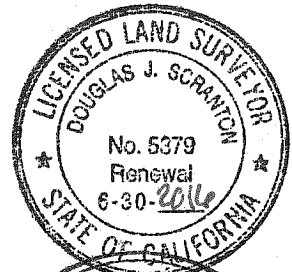

COUNTY SURVEYOR'S STATEMENT

This Corner Record was received JUNE 17, 2014 and examined

and filed JULY 3, 2014

Signed Richard G. Simonitch P.L.S. or R.C.E. No.: 7821



Title DEPUTY

County Surveyor's Comment _____



SCALE: 1"=60'

(LOT 27)

(LOT 25)

LOT 26
19 RM 23
SEE 1999 MAPS 224
AND PREVIOUS
CORNER RECORD

THIS CORNER
RECORD

FORMER LOT LINE

R=205.00'
D=16°43'40"
L=59.85'

S80°44'42"E
(RADIAL)

N09°15'18"E
111.33'

BASIS OF BEARINGS
S09°15'18"W 111.33'

HELD POSITION

N80°44'42"W
(RADIAL)

R=210.00'
D=38°41'25"
L=141.81'

N60°33'53"E
(RADIAL)

S55°54'42"E 290.03'

N34°05'18"E
28.22'

NOTE:
NO EASEMENTS OF ANY
KIND ARE SHOWN.

ALL DISTANCES GIVEN IN FEET
AND DECIMALS THEREOF

BASIS OF BEARINGS

TAKEN AS S 09°15'18" W BETWEEN MONUMENTS
AS SHOWN ON GILMARTIN DRIVE AND AS SAID
MONUMENTS ARE DEPICTED UPON 19 RM 23

LEGEND

- SET 1/2" REBAR WITH CAP
STAMPED " SCRANTON, PLS 5379 "
- STANDARD SUBDIVISION
MONUMENT
- LS 3971 PER 19 RM 23

MAP OF DEL MAR SUBDIVISION

(19 RM 23)

SITUS: APN 39-290-55