

**CORNER RECORD**

Document Number APN 039-101-23

City of Tiburon

County of Marin, California

Brief Legal Description Lot 20 of 8 RM 12

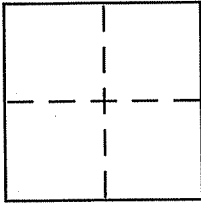

**CORNER TYPE**

Government Corner  Control   
Meander  Property   
Rancho  Other   
Date of Survey 11-01-10

**COORDINATES (Optional)**

N. \_\_\_\_\_  
E. \_\_\_\_\_  
Zone \_\_\_\_\_ NAD27  NAD83   
NAD83 Epoch \_\_\_\_\_  
Elev. \_\_\_\_\_  
Vert. Datum: NGVD29  NAVD88   
Meas. Units: Metric  Imperial

Corner - Left as found  Found and tagged  Established  Reestablished  Rebuilt

Identification and type of corner found: Evidence used to identify or procedure used to establish or reestablish the corner:

See page 2 of 2

A description of the physical condition of the monument as found and as set or reset:

See page 2 of 2

**SURVEYOR'S STATEMENT**

This Corner Record was prepared by me or under my direction in conformance with the Land Surveyor's Act on 6 December 2010

Signed [Signature] P.L.S. or R.C.E. No. 6784

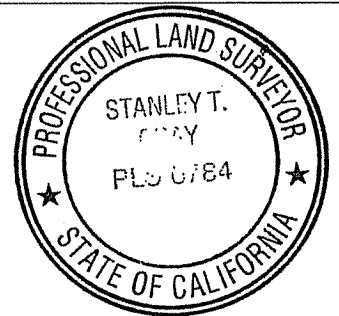

**COUNTY SURVEYOR'S STATEMENT**

This Corner Record was received DECEMBER 13, 2010

and examined and filed DECEMBER 14, 2010

Signed [Signature] P.L.S. or R.C.E. No. 7128

Title COUNTY SURVEYOR



County Surveyor's Comment \_\_\_\_\_

S66'00"00"W

SEAFIRTH PLACE  
40' & VARIABLE WIDTH

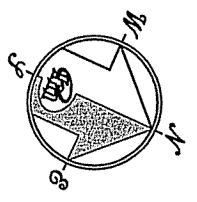

GRAPHIC SCALE  
1 INCH = 20 FEET



20.00'

N24'00"00"W

N66'00"00"E  
118.93'

2" X 15 GUY WIRE EASEMENT  
PER 8 RM 12

L=5.48  
Δ=3'55"50"  
R=80.000

APN 039-101-24  
LOT 21

APN 039-101-22  
LOT 19

S24'00"00"E  
85.06'

APN 039-101-23  
LOT 20

8 R M 1 2

N64'01"10"E  
130.03'

APN 039-101-20  
LOT 17

APN 039-101-21  
LOT 18

NOTE  
RECORD=MEASURED

### REFERENCE

[A] "MAP OF SEAFIRTH SUBDIVISION, MARIN, CALIFORNIA" FILED FOR RECORD JUNE 4, 1954 IN VOLUME 8 OF MAPS, AT PAGE 12, MARIN COUNTY RECORDS.

### LEGEND

- FOUND CITY MONUMENT
- SET 5/8" REBAR WITH CAP, PLS 6784
- FOUND 5/8" REBAR WITH CAP, PLS 6784 PER [A]

### CORNER RECORD

**MERIDIAN SURVEYING**  
ENGINEERING, INC.

1812 UNION STREET  
SAN FRANCISCO, CA 94123  
(415) 440-4131  
info@meridiansurvey.com

09077

777 GRAND AVENUE, SUITE 202  
SAN RAFAEL, CA 94901  
(415) 456-6450