

CORNER RECORD

038-440-21

Document Number I.N. 98-35283

City of TIBURON

County of MARIN, California

Brief Legal Description Lot 44, "Ring Mountain Subdivision", 20 Maps 49, Marin County Records.

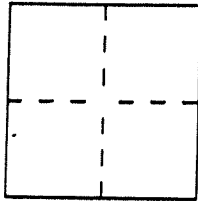

CORNER TYPE

Government Corner Control
 Meander Property
 Rancho Other
 Date of Survey 2 March 1999

COORDINATES (Optional)

N. _____
 E. _____
 Zone _____ Datum _____
 Elev. _____

Corner — Left as found Found and tagged Established Reestablished Rebuilt

Identification and type of corner found: Evidence used to identify or procedure used to establish or reestablish the corner:
Found nail & tag "RCE 22485" along northwesterly boundary and 3/4" I.D. iron pipe with plastic plug
"RCE 22485" at the southwesterly corner and northerly terminus of course "N23°26'38"W 68.40" of Lot 44
Ring Mountain Subdivision, recorded in Book 20 of Maps, at Page 49, Marin County Records.

A description of the physical condition of the monument as found and as set or reset: _____

As shown upon reverse side.

SURVEYOR'S STATEMENT

This Corner Record was prepared by me or under my direction in conformance with
 the Land Surveyors' Act on 2 March 1999.

Signed [Signature] L.S. or R.C.E. Number LS 4794

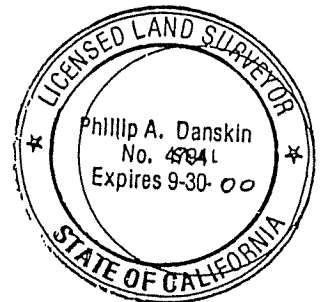

COUNTY SURVEYOR'S STATEMENT

This Corner Record was received March 16 1999 and examined
 and filed March 18 1999.

Signed John M. Wooley Title Deputy

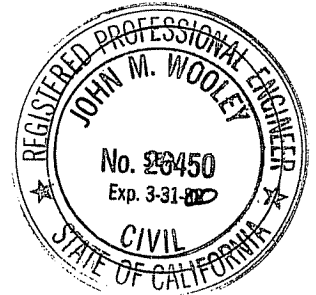

County Surveyor's Comment _____

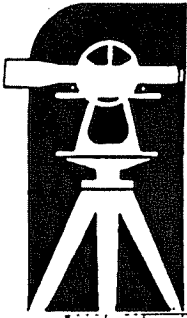

PHILLIP A. DANSKIN & ASSOCIATES

LAND SURVEYORS

Survey No. 521

For: Behrooz Sarafraz

#2 Mariposa Court

Tiburon, CA

94920

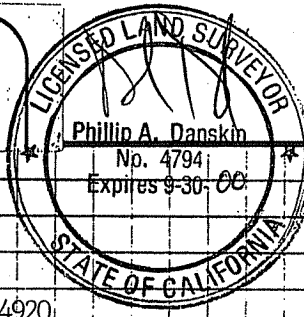

PARTIAL RETRACEMENT FOR FENCE CONSTRUCTION PURPOSES

