

CORNER RECORD

Agency Index 20-043
Document Number 038-391-14 ADJ.

City of BELVEDERE TIBURON County of MARIN, California
Brief Legal Description 17 Rm 86

CORNER TYPE

COORDINATES (Optional)

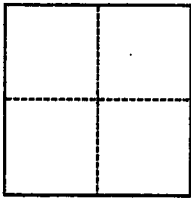

- Government Corner
- Meander
- Rancho
- Control
- Property
- Other

Date of Survey July 25, 2019

N. _____ E. _____
 Elevation _____
 Units Metric U.S. Survey Foot
 Horizontal Datum _____
 Zone _____
 Vertical Datum _____
 Complies with Public Resources Code §§8801-8819
 Complies with Public Resources Code §§8890-8902

- PLS Act Ref.: 8765(d) 8771 8773 Other:
- Corner/Monument: Left as found Established Rebuilt Pre-Construction
 Found and tagged Reestablished Referenced Post-Construction

Narrative of corner identified and monument as found, set, reset, replaced, or removed:
 See sheet #2 for description(s):

FOUND: 2X MARIN COUNTY MONUMENTS
SET: 4X CROSS CUT

SURVEYOR'S STATEMENT

This Corner Record was prepared by me or under my direction in conformance with
 the Professional Land Surveyors' Act on JULY 2019
 Signed [Signature] P.L.S. or R.C.E. No. RCE 14786



COUNTY SURVEYOR'S STATEMENT

This Corner Record was received 07/02/2020
 and examined and filed 09/16/2020
 Signed [Signature] P.L.S. or R.C.E. No. _____
 Title DEPUTY C.S.



County Surveyor's Comment

LEGEND

⊙ FOUND MARIN COUNTY MONUMENT

✕ SET REFERENCE POINT

APN
038-391-14

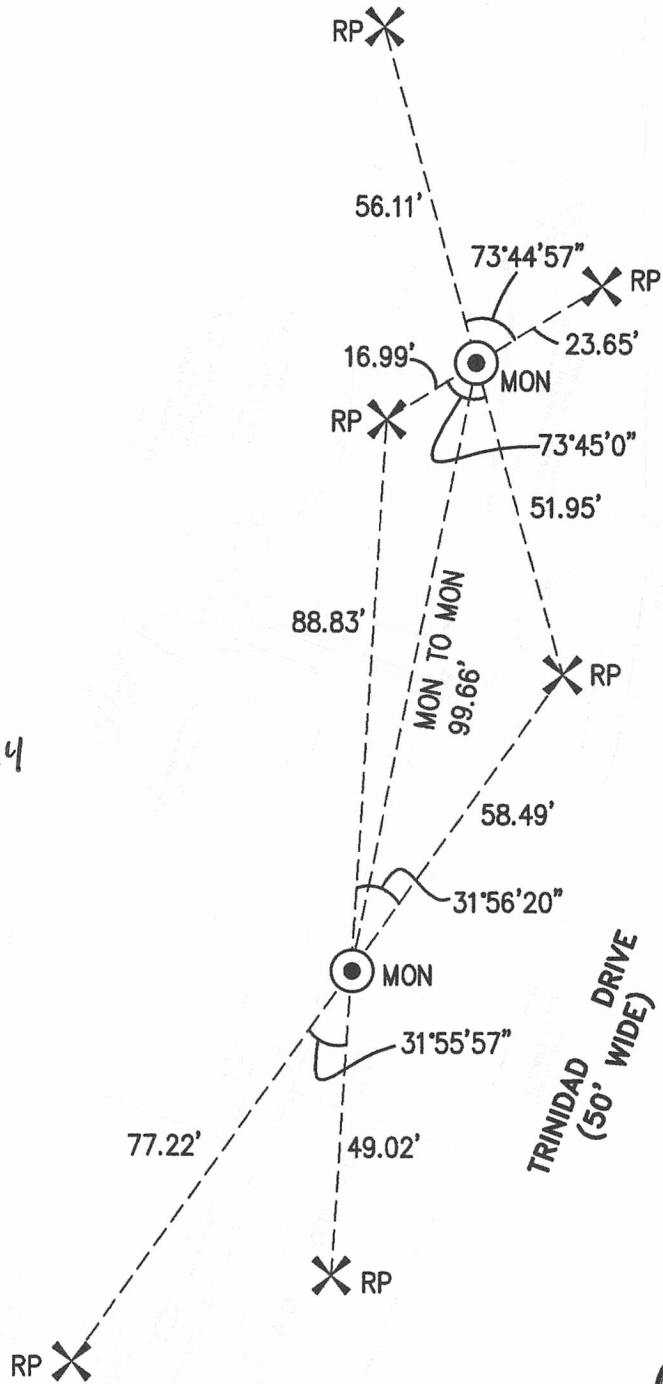

TRINIDAD DRIVE
(50' WIDE)

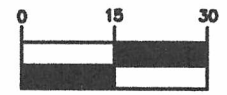

SCALE: 1" = 30'

KCA JOB# 6675

KCA ENGINEERS, INC.

CONSULTING ENGINEERS • SURVEYORS • PLANNERS

318 BRANNAN ST. • SAN FRANCISCO, CA 94107 • (415) 548-7111 • FAX: (415) 548-9472

PRE CONSTRUCTION CORNER RECORD
TRINIDAD PUMP STATION

MARIN COUNTY

CALIFORNIA

DATE:
JULY 2019

1 OF 1

CORNER RECORD

Agency Index 20-043 B
Document Number 638-391-14 ADJ

City of BELVEDERE TIBURON County of MARIN, California

Brief Legal Description 17 Rm 80

CORNER TYPE

COORDINATES (Optional)

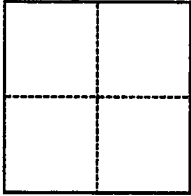

- Government Corner
- Meander
- Rancho
- Control
- Property
- Other

Date of Survey April 28, 2020

N. _____ E. _____
 Elevation _____
 Units Metric U.S. Survey Foot
 Horizontal Datum _____
 Zone _____
 Vertical Datum _____
 Complies with Public Resources Code §§8801-8819
 Complies with Public Resources Code §§8890-8902

- PLS Act Ref.: 8765(d) 8771 8773 Other:
- Corner/Monument: Left as found Established Rebuilt Pre-Construction
 Found and tagged Reestablished Referenced Post-Construction

Narrative of corner identified and monument as found, set, reset, replaced, or removed:
 See sheet #2 for description(s):

SET: 1X MARIN COUNTY MONUMENT RCE 14786
FOUND: 1X MARIN COUNTY MONUMENT

SURVEYOR'S STATEMENT

This Corner Record was prepared by me or under my direction in conformance with the Professional Land Surveyors' Act on APRIL 2020

Signed [Signature] P.L.S. or R.C.E. No. RCE 14786



COUNTY SURVEYOR'S STATEMENT

This Corner Record was received 07/02/2020 and examined and filed 09/16/2020

Signed [Signature] P.L.S. or R.C.E. No. 9292

Title DEPUTY C.S.

County Surveyor's Comment



LEGEND

- FOUND MARIN COUNTY MONUMENT WITH BRASS DISC IN CONCRETE BASE, LABELED MARIN COUNTY PUBLIC WORKS.
- ✕ FOUND CROSS CUT
- SET CONCRETE MONUMENT IN HAND HOLE WITH BRASS DISC STAMPED RCE 14786 TO REPLACE MARIN COUNTY MONUMENT SURVEYED IN APRIL 2020.

APN
038-391-14

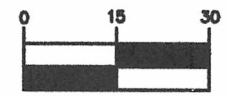
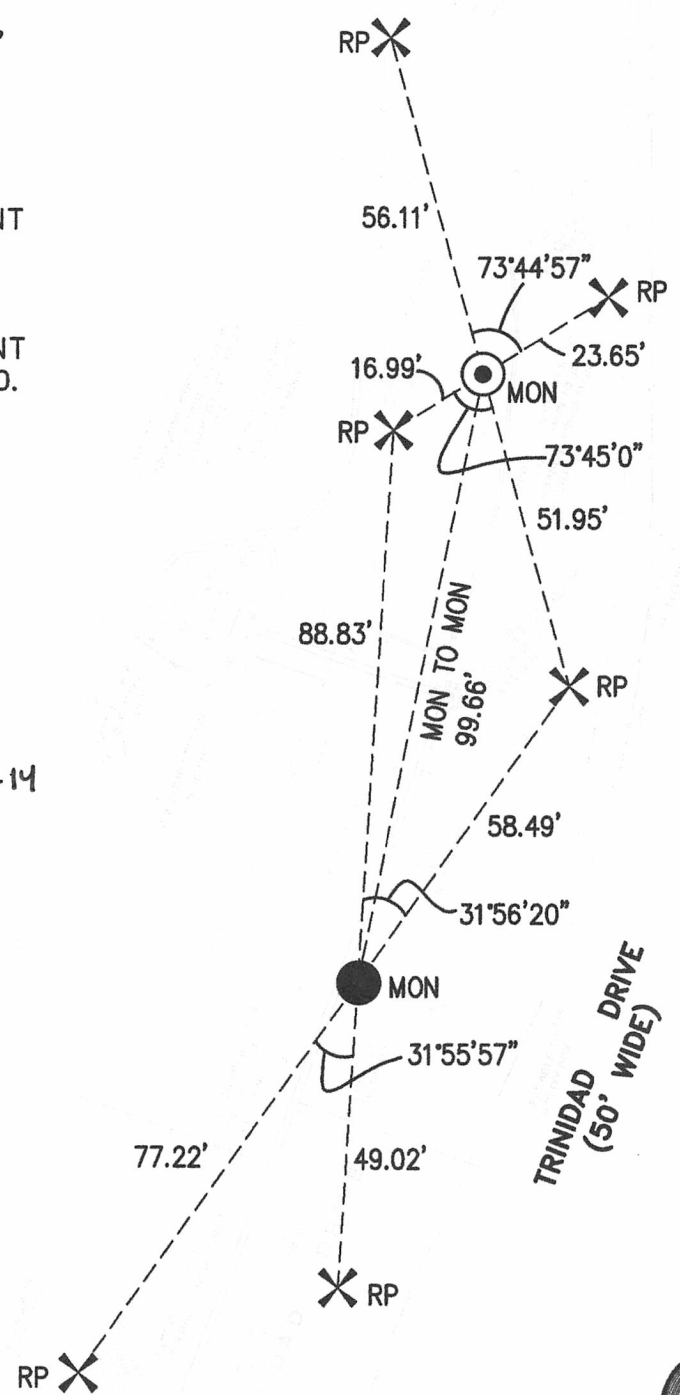

SCALE: 1" = 30'

KCA JOB# 6675

KCA ENGINEERS, INC.
 CONSULTING ENGINEERS • SURVEYORS • PLANNERS
 318 BRANNAN ST. • SAN FRANCISCO, CA 94107 • (415) 548-7111 • FAX: (415) 548-9472

POST CONSTRUCTION CORNER RECORD
 TRINIDAD PUMP STATION
 MARIN COUNTY CALIFORNIA

DATE:
 APRIL 2020
 1 OF 1