

# CORNER RECORD

Agency Index DPW #19-067

Document Number APN 034-420-37 ADJ

City of CORTE MADERA County of MARIN, California

Brief Legal Description CENTERLINE MONUMENT IN FRONT OF PARCEL E PER 21 RM 8

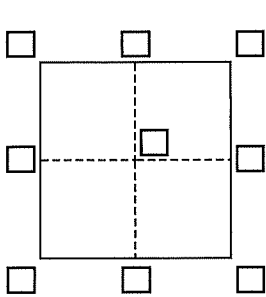

### CORNER TYPE

- Government Corner  Control   
 Meander  Property   
 Rancho  Other

Date of Survey April 8, 2019

### COORDINATES (Optional)

- N. \_\_\_\_\_ E. \_\_\_\_\_  
 Elevation \_\_\_\_\_  
 Units Metric  U.S. Survey Foot   
 Horizontal Datum \_\_\_\_\_  
 Zone \_\_\_\_\_ Epoch Date \_\_\_\_\_  
 Vertical Datum \_\_\_\_\_  
 Complies with Public Resources Code §§8801-8819  
 Complies with Public Resources Code §§8890-8902

- PLS Act Ref.:  8765(d)  8771  8773  Other:  
 Corner/Monument:  Left as found  Established  Rebuilt  Pre-Construction  
 Found and tagged  Reestablished  Referenced  Post-Construction

Narrative of corner identified and monument as found, set, reset, replaced, or removed:  
 See sheet #2 for description(s):

### SURVEYOR'S STATEMENT

This Corner Record was prepared by me or under my direction in conformance with the Professional Land Surveyors' Act on 9/16/19.  
 Signed [Signature] P.L.S. or R.C.E. No. 9387

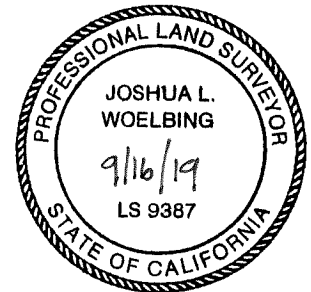

### COUNTY SURVEYOR'S STATEMENT

This Corner Record was received July 1, 2019  
 and examined and filed OCT. 07, 2019.  
 Signed [Signature] P.L.S. or R.C.E. No. 9292  
 Title DEPUTY C.S.



County Surveyor's Comment

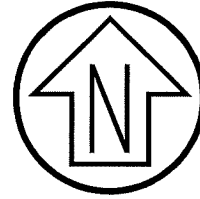

Graphic Scale (in feet)



1 inch = 10 ft.

**PARCEL E**  
**(21 RM 8)**  
**APN 034-420-37**

SET NAIL & BRASS  
TAG PLS 9387

SET NAIL & BRASS  
TAG PLS 9387

N03°23'44"W  
15.01'

59°05'18"

N55°41'34"E  
19.51'

164°53'39"

106°39'23"

**MEADOW RIDGE DRIVE**

S11°42'37"W  
15.90'

29°21'40"

S17°39'03"E  
15.82'

SET NAIL & BRASS  
TAG PLS 9387

SET NAIL & BRASS  
TAG PLS 9387

**LEGEND**

- BOUNDARY
- CENTERLINE MONUMENT
- TIE TO PRE-CONSTRUCTION
- REFERENCE POINT
- SET NAIL & BRASS TAG PLS 9387
- STREET MONUMENT PER 21 RM 08

**PARCEL E**  
**(21 RM 8)**  
**APN 034-420-37**

**CSW | ST 2**

**CSW/Stuber-Stroeh Engineering Group, Inc.**  
Civil & Structural Engineers | Surveying & Mapping | Environmental Planning  
Land Planning | Construction Management  
45 Leveroni Court  
Novato, CA 94949  
tel: 415.883.9850  
fax: 415.883.9835  
<http://www.cswst2.com>  
© 2019

Rev. X

Date: 09/16/19

Job No. 2019-20-028

Scale: 1" = 10'

**MONUMENT PRESERVATION  
CORNER RECORD  
MEADOW RIDGE DRIVE**

CORTE MADERA

MARIN

CALIFORNIA