

# CORNER RECORD

Agency Index DPW # 19-082  
Document Number APN034-420-18 ADJ

City of CORTE MADERA County of MARIN, California  
Brief Legal Description FOUND OPEN 3/4" IRON PIPE AT MEADOW RIDGE DRIVE & PRIV. ROAD

CORNER TYPE		COORDINATES (Optional)	
<input type="checkbox"/> Government Corner	<input type="checkbox"/> Control	N. _____	E. _____
<input type="checkbox"/> Meander	<input type="checkbox"/> Property	Elevation _____	
<input type="checkbox"/> Rancho	<input type="checkbox"/> Other	Units <input checked="" type="checkbox"/> Metric <input type="checkbox"/> U.S. Survey Foot <input checked="" type="checkbox"/>	
Date of Survey <u>April 8, 2019</u>		Horizontal Datum _____	
		Zone _____ Epoch Date _____	
		Vertical Datum _____	
		<input type="checkbox"/> Complies with Public Resources Code §§8801-8819	
		<input type="checkbox"/> Complies with Public Resources Code §§8890-8902	

PLS Act Ref.:	<input type="checkbox"/> 8765(d)	<input checked="" type="checkbox"/> 8771	<input type="checkbox"/> 8773	<input type="checkbox"/> Other:
Corner/Monument:	<input type="checkbox"/> Left as found	<input type="checkbox"/> Established	<input type="checkbox"/> Rebuilt	<input checked="" type="checkbox"/> Pre-Construction
	<input type="checkbox"/> Found and tagged	<input type="checkbox"/> Reestablished	<input type="checkbox"/> Referenced	<input type="checkbox"/> Post-Construction

Narrative of corner identified and monument as found, set, reset, replaced, or removed:  
 See sheet #2 for description(s):

### SURVEYOR'S STATEMENT

This Corner Record was prepared by me or under my direction in conformance with the Professional Land Surveyors' Act on 7/19/19.  
Signed [Signature] P.L.S. or R.C.E. No. 9387

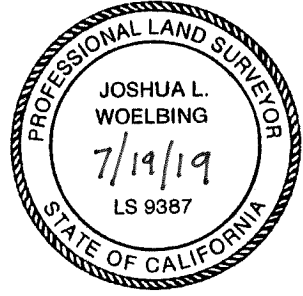

### COUNTY SURVEYOR'S STATEMENT

This Corner Record was received July 23, 2019 and examined and filed SEP. 04, 2019.  
Signed [Signature] P.L.S. or R.C.E. No. 9292  
Title DEPUTY C.S.



County Surveyor's Comment

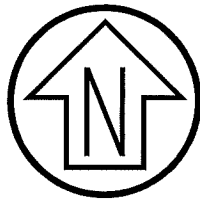

Graphic Scale (in feet)

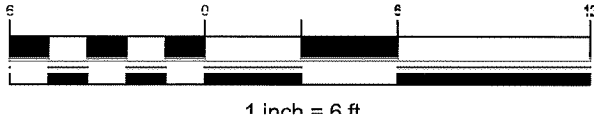

**LOT 135**  
**(21 RM 8)**  
**APN 034-420-18**

**LOT 138**  
**(21 RM 8)**  
**APN 034-420-21**

SET NAIL & BRASS  
TAG PLS 9387

SET NAIL & BRASS  
TAG PLS 9387

SET NAIL & BRASS  
TAG PLS 9387

N86°04'05"W  
11.28'

N24°52'11"W  
14.26'

S72°26'17"E  
10.01'

MEADOW RIDGE DRIVE  
166°22'12"

132°25'54"

**LEGEND**

- BOUNDARY
- CENTERLINE MONUMENT
- TIE TO PRE-CONSTRUCTION
- REFERENCE POINT
- SET NAIL & BRASS TAG PLS 9387
- FOUND OPEN 3/4" IRON PIPE

**CSW ST2**

**CSW/Stuber-Stroeh Engineering Group, Inc.**

Civil & Structural Engineers | Surveying & Mapping | Environmental Planning  
Land Planning | Construction Management

45 Leveroni Court  
Novato, CA 94949

tel: 415.883.9850  
fax: 415.883.9835

<http://www.cswst2.com>

© 2019

Rev. X

Date: 07/17/19

Job No. 2019-20-028

Scale: 1" = 6'

**MONUMENT PRESERVATION  
CORNER RECORD**  
**PRIVATE ROAD AND MEADOW RIDGE DRIVE**  
**CORTE MADERA MARIN CALIFORNIA**