

CORNER RECORD

Agency Index

Document Number

DRW# 19-069
APN 034-412-05 ADJ

City of CORTE MADERA County of MARIN, California

Brief Legal Description CENTERLINE MONUMENT IN FRONT OF LOT 106 PER 21 RM 8

CORNER TYPE		COORDINATES (Optional)	
<input type="checkbox"/> Government Corner	<input type="checkbox"/> Control	N. _____	E. _____
<input type="checkbox"/> Meander	<input type="checkbox"/> Property	Elevation _____	
<input type="checkbox"/> Rancho	<input type="checkbox"/> Other	Units <input checked="" type="checkbox"/> Metric <input type="checkbox"/> U.S. Survey Foot <input checked="" type="checkbox"/>	
Date of Survey <u>April 8, 2019</u>		Horizontal Datum _____	
		Zone _____ Epoch Date _____	
		Vertical Datum _____	
		<input type="checkbox"/> Complies with Public Resources Code §§8801-8819	
		<input type="checkbox"/> Complies with Public Resources Code §§8890-8902	

PLS Act Ref.:	<input type="checkbox"/> 8765(d)	<input checked="" type="checkbox"/> 8771	<input type="checkbox"/> 8773	<input type="checkbox"/> Other:
Corner/Monument:	<input type="checkbox"/> Left as found	<input type="checkbox"/> Established	<input type="checkbox"/> Rebuilt	<input checked="" type="checkbox"/> Pre-Construction
	<input type="checkbox"/> Found and tagged	<input type="checkbox"/> Reestablished	<input type="checkbox"/> Referenced	<input type="checkbox"/> Post-Construction

Narrative of corner identified and monument as found, set, reset, replaced, or removed:
 See sheet #2 for description(s):

SURVEYOR'S STATEMENT

This Corner Record was prepared by me or under my direction in conformance with the Professional Land Surveyors' Act on 9/17/19.
Signed [Signature] P.L.S. or R.C.E. No. 9387

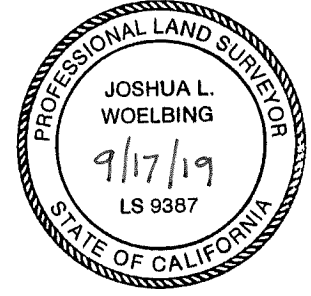

COUNTY SURVEYOR'S STATEMENT

This Corner Record was received July 1, 2019 and examined and filed OCT. 03, 2019.
Signed [Signature] P.L.S. or R.C.E. No. 9292
Title DEPUTY C.S.



County Surveyor's Comment

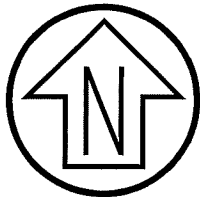

Graphic Scale (in feet)

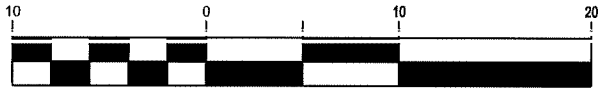

1 inch = 10 ft.

MEADOW RIDGE DRIVE

LOT 106
(21 RM 8)

SET NAIL & BRASS
TAG PLS 9387

160°54'27"

N61°27'59"E
20.97'

SET NAIL & BRASS
TAG PLS 9387

S80°33'32"W
24.02'

16°24'05"

S12°17'20"E
28.01'

106°14'41"

LOT 125
(21 RM 8)

SET NAIL & BRASS
TAG PLS 9387

S64°09'27"W
20.18'

76°26'47"

LOT 107
(21 RM 8)

LOT 126
(21 RM 8)

SET NAIL & BRASS
TAG PLS 9387

LEGEND

- BOUNDARY
- CENTERLINE MONUMENT
- TIE TO PRE-CONSTRUCTION
- REFERENCE POINT
- SET NAIL & BRASS TAG PLS 9387
- STREET MONUMENT PER 21 RM 08

CSW ST2

CSW/Stuber-Stroeh Engineering Group, Inc.

Civil & Structural Engineers | Surveying & Mapping | Environmental Planning
Land Planning | Construction Management

45 Leveroni Court
Novato, CA 94949

tel: 415.883.9850
fax: 415.883.9835

<http://www.cswst2.com>

© 2019

Rev. X

Job No. 2019-20-028

Date: 09/16/19

Scale: 1" = 10'

**MONUMENT PRESERVATION
CORNER RECORD
MEADOW RIDGE DRIVE**

CORTE MADERA

MARIN

CALIFORNIA