

# CORNER RECORD

City of Mill Valley

Document Number APN 033-193-08

Brief Legal Description: Parcel 1 "Parcel Map, Lands of Marin County Open Space District, 3476 O.R. 583 Parcel D", recorded in Book 20 of Parcel Maps at Page 68, Marin County Records.

County of Marin, California

## CORNER TYPE

Government Corner   
Meander   
Rancho   
Date of Survey July 2006

Control   
Property   
Other

## COORDINATES

(Optional)

N. \_\_\_\_\_  
E. \_\_\_\_\_  
Zone \_\_\_\_\_ Datum \_\_\_\_\_

Corner --Left as found  Found and tagged  Established  Reestablished  Rebuilt

Identification and type of corner found: Evidence used to identify or procedure used to establish or reestablish the corner.

This survey is based upon found monuments shown on that certain Map entitled "Parcel Map, Lands of Marin County Open Space District, 3476 O.R. 583 Parcel D", recorded in Book 20 of Parcel Maps at Page 68, Marin County Records.

A Description of the physical condition of the monument as found and as set or reset.

See Sheet two.

## SURVEYOR'S STATEMENT

This Corner Record was prepared by me or under my direction in conformance with the Professional Land Act on 12-13 2006.

Signed Linda A. Carruthers P.L.S. 7053

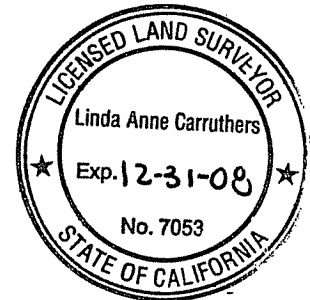

## COUNTY SURVEYOR'S STATEMENT

This Corner Record was received DECEMBER 14, 2006 and examined and filed DECEMBER 18, 2006.

Signed [Signature] Title COUNTY SURVEYOR



County Surveyor's Comments \_\_\_\_\_

# OVERHILL RD.

## MARIN COUNTY OPEN SPACE DISTRICT

L=18.15'  
R=160.00'  
Δ=06°30'00"

L=158.42 R=152.43  
Δ=59°32'41"

LOT 72  
12 RM 100

40' ROAD R/W RESERVATION  
TO THE COUNTY OF MARIN  
D.N. 83-25249

20' R/W MMWD EASEMENT  
1946 O.R. 278

PARCEL 1  
20 PM 68

L=24.15'  
R=140.00'  
Δ=09°53'06"

OPEN SPACE  
RESTRICTION

OPEN SPACE  
RESTRICTION

OPEN SPACE RESTRICTION  
D.N. 83-25249

SEE DETAIL "A"  
FOR TIES

S 58°00'00" E 118.00'

S 36°03'  
18°20'06" E

N 18°20'06" W 41.12'

N 32°00'00" E 48.75'

N 32°00'00" E 100.00'

75.99'

N 58°00'00" W

162.08'

N 54°23'02" W

FOUND 1/2" FORM STAKE

DETAIL "A"  
N.T.S.

ESCALON DR.

R=358'  
L=82.135'  
Δ=13°08'43"

L=158.435'  
R=152.535'  
Δ=59°30'43"

LOT 72  
12 RM 100

20 PM 68

OVERHILL RD.  
L=211.774' R=425'  
Δ=28°33'  
S 20°25'00" E 170.50'

FOUND STANDARD  
CITY MONUMENT

## MARIN COUNTY OPEN SPACE DISTRICT

### LEGEND

- SET 5/8" REBAR & CAP P.L.S. 7053
- SET NAIL & BRASS TAG P.L.S. 7053

### NOTE:

ALL DISTANCES AND DIMENSIONS ARE  
IN FEET AND DECIMALS THEREOF.

LINDA A. CARRUTHERS & ASSOCIATES  
2015 BRIDGEWAY, STE. 301D  
SAUSALITO, CA 94965

BOUNDARY SURVEY - 20 PM 68  
18 OVERHILL ROAD, MILL VALLEY

SCALE: 1"=20' SHEET 2 OF 2 DATE: JULY 2006  
JOB NO. 06-604CR APN 033-193-08