

**CORNER RECORD**

Document Number APN 33-101-41

City of Mill Valley

County of MARIN, California

Brief Legal Description Parcel 1, 24 P.M. 44 / APN 33-101-41

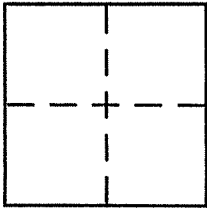

**CORNER TYPE**

Government Corner  Control   
Meander  Property   
Rancho  Other   
Date of Survey \_\_\_\_\_

**COORDINATES (Optional)**

N. \_\_\_\_\_  
E. \_\_\_\_\_  
Zone \_\_\_\_\_ NAD27  NAD83   
NAD83 Epoch \_\_\_\_\_  
Elev. \_\_\_\_\_  
Vert. Datum: NGVD29  NAVD88   
Meas. Units: Metric  Imperial

Corner - Left as found  Found and tagged  Established  Reestablished  Rebuilt

Identification and type of corner found: Evidence used to identify or procedure used to establish or reestablish the corner:

See Back

A description of the physical condition of the monument as found and as set or reset:

See Back

**SURVEYOR'S STATEMENT**

This Corner Record was prepared by me or under my direction in conformance with

the Land Surveyor's Act on May 3 2004

Signed Michael A. Brogan P.L.S or R.C.E. No. LS 5767

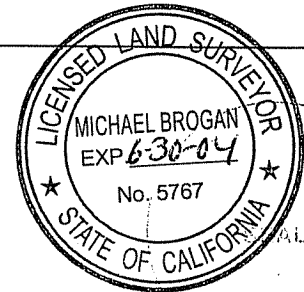

**COUNTY SURVEYOR'S STATEMENT**

This Corner Record was received MAY 4, 2004

and examined and filed MAY 4, 2004

Signed \_\_\_\_\_ P.L.S or R.C.E. No. 7128

Title COUNTY SURVEYOR

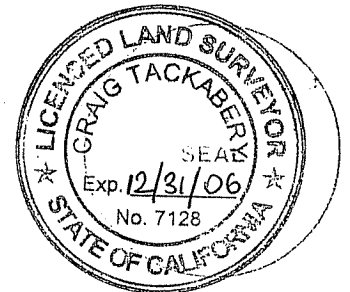

County Surveyor's Comment \_\_\_\_\_

