

CORNER RECORD

Document Number A.P. # 28-053-10,11

City of Mill Valley

County of MARIN, California

Brief Legal Description APN 28-053-10/11, PCLs 192 of 19 PM-67

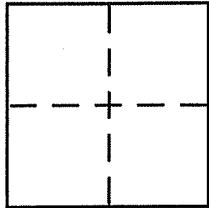

CORNER TYPE

Government Corner Control
Meander Property
Rancho Other
Date of Survey _____

COORDINATES (Optional)

N. _____
E. _____
Zone _____ NAD27 NAD83
NAD83 Epoch _____
Elev. _____
Vert. Datum: NGVD29 NAVD88
Meas. Units: Metric Imperial

Corner - Left as found Found and tagged Established Reestablished Rebuilt

Identification and type of corner found: Evidence used to identify or procedure used to establish or reestablish the corner:

See Back

A description of the physical condition of the monument as found and as set or reset:

See Back

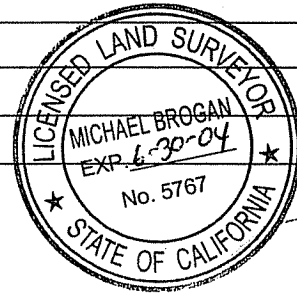

SURVEYOR'S STATEMENT

This Corner Record was prepared by me or under my direction in conformance with the Land Surveyor's Act on November 7 2003

Signed Michael A. Brogan P.L.S or R.C.E. No. LS 5767

COUNTY SURVEYOR'S STATEMENT

This Corner Record was received NOVEMBER 10, 2003

and examined and filed NOVEMBER 19, 2003

Signed [Signature] P.L.S or R.C.E. No. 7128

Title COUNTY SURVEYOR

County Surveyor's Comment _____

