

# CORNER RECORD

Document Number A.P. # 25-194-05

City of CORTE MADERA

County of MARIN, California

Brief Legal Description LOT 36B, CHAPMAN PARK MAP TWO, CORTE MADERA, 2 R.M. 73

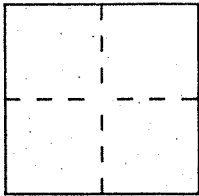

### CORNER TYPE

Government Corner  Control   
 Meander  Property   
 Rancho  Other   
 Date of Survey 4/27/94

### COORDINATES (Optional)

N. \_\_\_\_\_  
 E. \_\_\_\_\_  
 Zone \_\_\_\_\_ Datum \_\_\_\_\_  
 Elev. \_\_\_\_\_

Corner — Left as found  Found and tagged  Established  Reestablished  Rebuilt

Identification and type of corner found: Evidence used to identify or procedure used to establish or reestablish the corner:

FOUND 3/4" IRON PIPE WITH TAG RCE5948 AS SHOWN ON ATTACHED DIAGRAM.

FOUND HUB WITH TAG RCE 12247 AS SHOWN ON ATTACHED DIAGRAM.

METHOD: FIELD TRAVERSE TIES BASED ON PREVIOUS SURVEY, 30 O.S. 94, TO

FOUND AND ACCEPTED CORNERS. REESTABLISHED OBLITERATED CORNERS PER  
RECORD POSITION.

A description of the physical condition of the monument as found and as set or reset:

CORNERS IN GOOD CONDITION. REESTABLISHED CORNERS WITH SET 1/2" IRON  
PINS WITH CAP "LS6234".

### SURVEYOR'S STATEMENT

This Corner Record was prepared by me or under my direction in conformance with  
 the Land Surveyors' Act on APRIL 25 19 94.

Signed Robert A. Walling L.S. or ~~XXX~~ Number LS6234

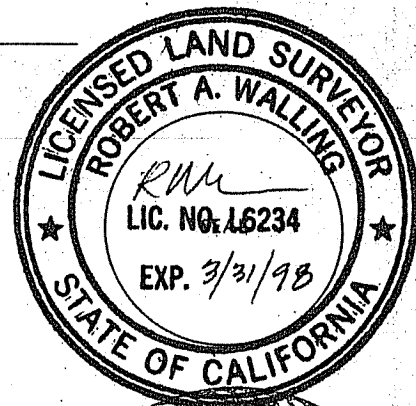

### COUNTY SURVEYOR'S STATEMENT

This Corner Record was received MAY 5 19 94 and examined

and filed S-10 19 94.

Signed [Signature] Title DES

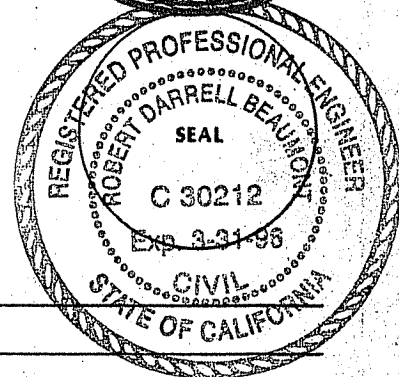

County Surveyor's Comment \_\_\_\_\_

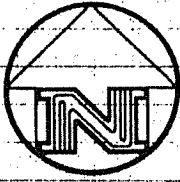

SCALE: 1"=50'

36A

SET 1/2" IRON PINS  
W/CAP "LS6234"

PER 2 R.M. 73  
N 82° 29' W 133.10'

FD. 1/2" I.P. W/TAG  
"RCE 5948"  
PER 2 O.S. 106

2 R.M. 73  
36B

LANDS OF

MARGOLIS

36C

FD. HUB W/TAG "RCE 12247"  
PER 11 R.M. 70

N 5° 50' W  
PER 2 O.S. 106

S 64° 08' W  
100.10'  
PER 30 O.S. 94

FD. HUB W/TACK  
PER 2 O.S. 106

SET 1/2" IRON PIN  
W/CAP "LS6234"

S 64° 09' 30" W  
111.45'  
PER 30 O.S. 94

2 R.M. 73  
35A

30 O.S. 94

35B

N 38° 01' W  
106.06'  
PER 30 O.S. 94

DRIVE

CHAPMAN

CHAPMAN  
DRIVE

STETSON

N 1° 49' 39" E (SOUTH PER 2 R.M. 73)  
39.12' PER 11 R.M. 70

S 13° 30' 35" W  
PER 11 R.M. 70

S 13° 30' 35" W  
PER 11 R.M. 70

2 R.M. 73  
35A

30 O.S. 94

35B

DRIVE

CHAPMAN

CHAPMAN  
DRIVE